

FOR AFM  
SERIES #69  
NEW STYLE WALL HYDRANT

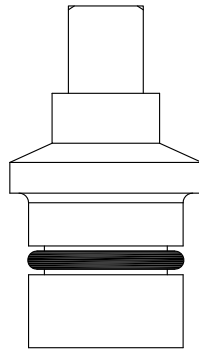

TAPPED  $\frac{3}{8}$ "-16  
VALVE SCREW  
283020

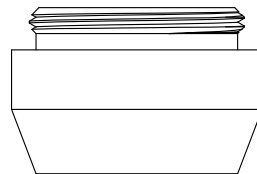

O-RING GLAND  
983020

# FOR GREENBERG

PACKING NUT  
383150

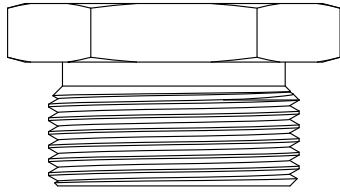

HEAD NUT  
109540

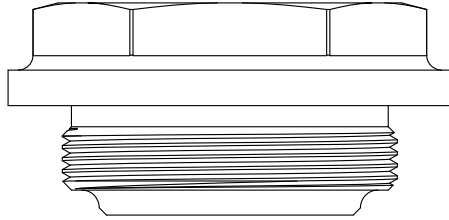

STREET WASHER  
STEM  
283152

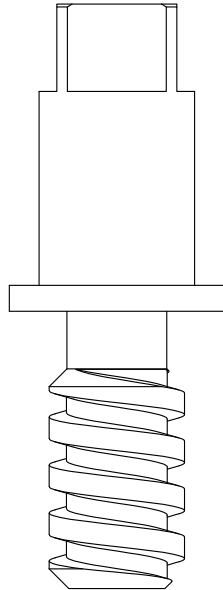

PLUNGER  
983152

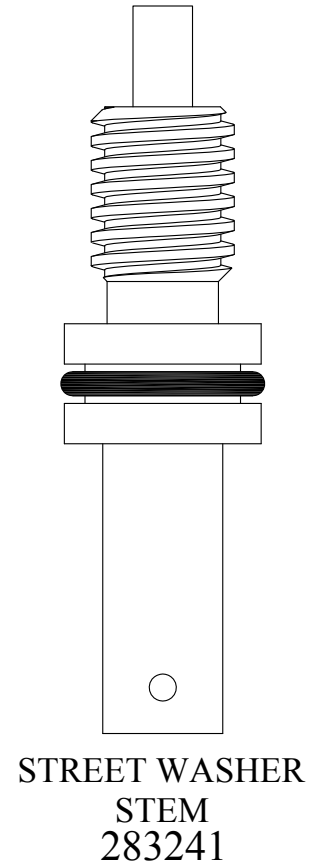
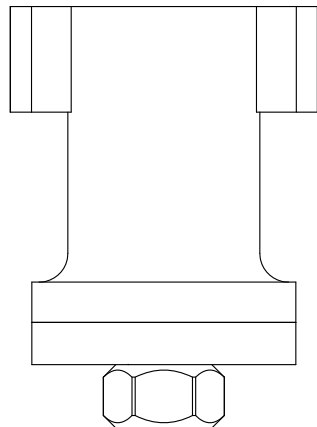

STREET WASHER  
STEM  
283241

# FOR JOSAM

## SERIES #Y-200

### FREEZELESS WALL HYDRANT

PROVIDE YOUR NEEDED LENGTH FOR A QUOTE ON COMPLETE PLUNGER & OPERATOR ASSEMBLY, OR ORDER PART NUMBERS 283431 & 983430 (OR 983410 - OLD STYLE) AND USE THREADED ROD TO MAKE YOUR OWN CUSTOM LENGTH

OLD STYLE  
ASSEMBLY NOT  
AVAILABLE

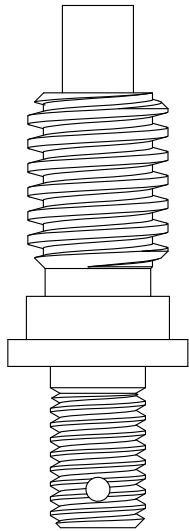

FOR OLD STYLE  
ASSEMBLY ORDER  
NEW STYLE PARTS  
AND SUBSTITUTE  
983410 IN PLACE  
OF 983430

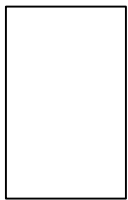
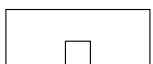
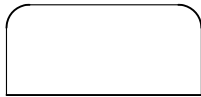

TAPPED  $\frac{3}{8}$ "-16

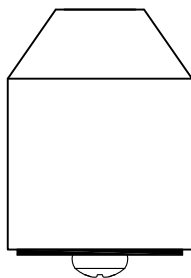

OLD  
STYLE  
PLUNGER  
983410

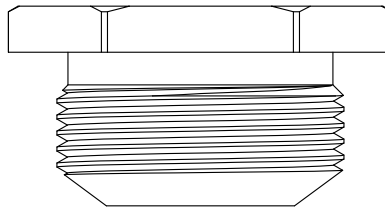

HEAD NUT  
783411



646840

NEW STYLE

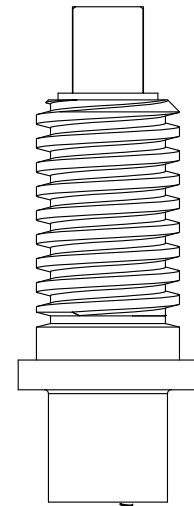

OPERATING  
SCREW  
283431

TAPPED  $\frac{3}{8}$ "-16

DRAIN PORT  
SLEEVE  
683430

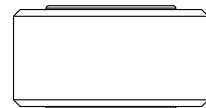

RETAINING  
WASHER  
883430

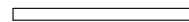

RETAINING  
NUT  
383430

TAPPED THRU  
 $\frac{3}{8}$ "-16

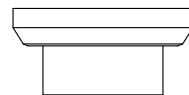

NEW  
STYLE  
PLUNGER  
983430

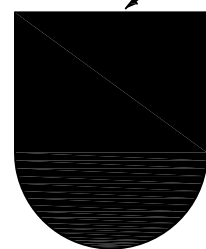

TAPPED  $\frac{3}{8}$ "-16

# FOR JOSAM

## SERIES #Y-210

### FREEZELESS WALL HYDRANT

PROVIDE YOUR NEEDED LENGTH FOR A QUOTE ON COMPLETE PLUNGER & OPERATOR ASSEMBLY, OR ORDER PART NUMBERS 285001 & 985000 AND USE THREADED ROD TO MAKE YOUR OWN CUSTOM LENGTH

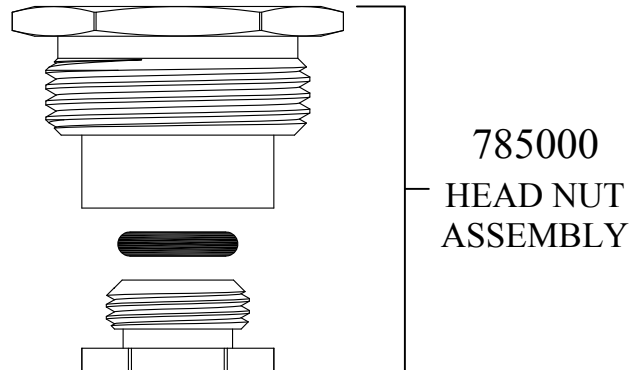

OLD STYLE

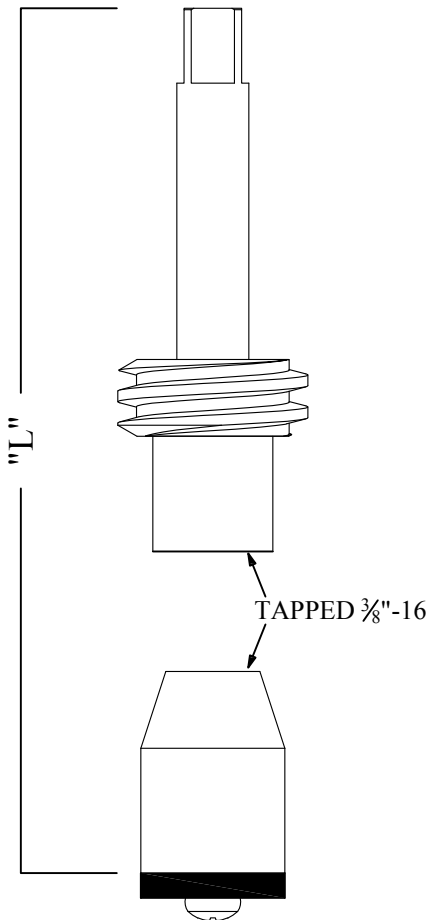
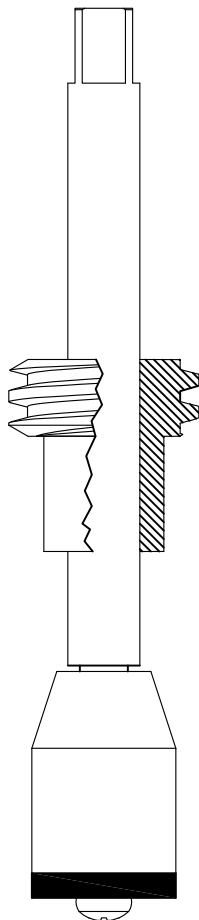

GUIDE SCREW  
285001

PLUNGER  
985000

# FOR JOSAM

## HYDRASAN I FREEZELESS WALL HYDRANT

ORDER ORIGINAL STYLE ROD ASSEMBLY BY PART # IN THE TABLE  
BELOW, OR ORDER PART NUMBERS 147950 & 148020 AND USE  
THREADED ROD TO MAKE YOUR OWN CUSTOM LENGTH

CAP RETAINER  
983110

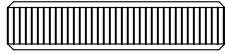

DRAW NUT  
783112

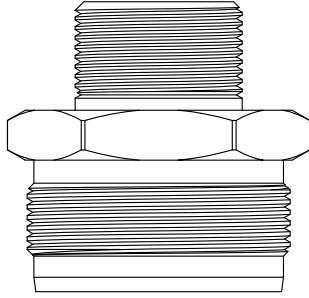

ACTUATOR  
WITH  
O-RING &  
SCREW  
283112

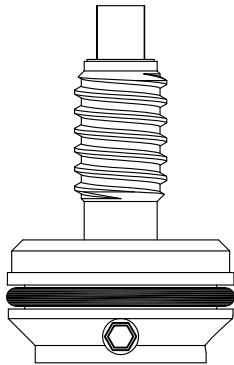

UPPER ROD  
END  
147950

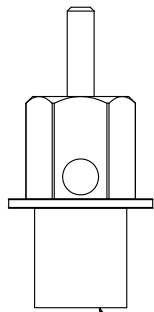

WARM CLIMATE  
ROD  
683110

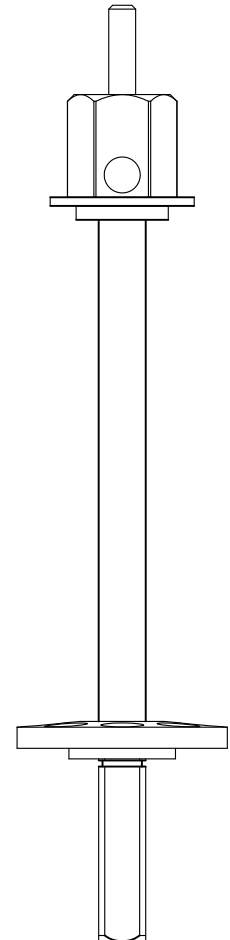
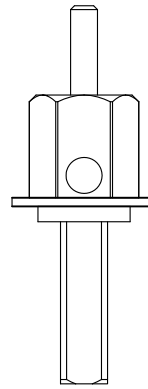

ROD ASSY PART#	LENGTH "L"	WALL THICKNESS	
		71000	71050
683110-4	4 7/8"	4	2
683110-6	6 7/8"	6	4
683110-8	8 7/8"	8	6
683110-10	10 7/8"	10	8
683110-12	12 7/8"	12	10
683110-14	14 7/8"	14	12
683110-16	16 7/8"	16	14
683110-18	18 7/8"	18	16
683110-20	20 7/8"	20	18
683110-22	22 7/8"	22	20
683110-24	24 7/8"	24	22
683110-26	26 7/8"	-	24

LOWER ROD  
END  
148020

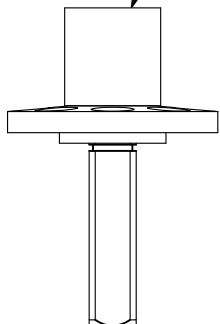

TAPPED 3/8"-16

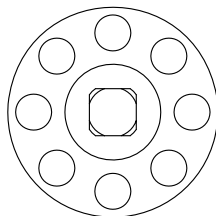

BOTTOM VIEW

*Send Your Orders To:*

BARRY E.  SR. CO.

*E-mail: [orderdesk@barrywalter.com](mailto:orderdesk@barrywalter.com)*

*Fax: 1.800.886.9831*

*Phone: 1.800.767.5552*

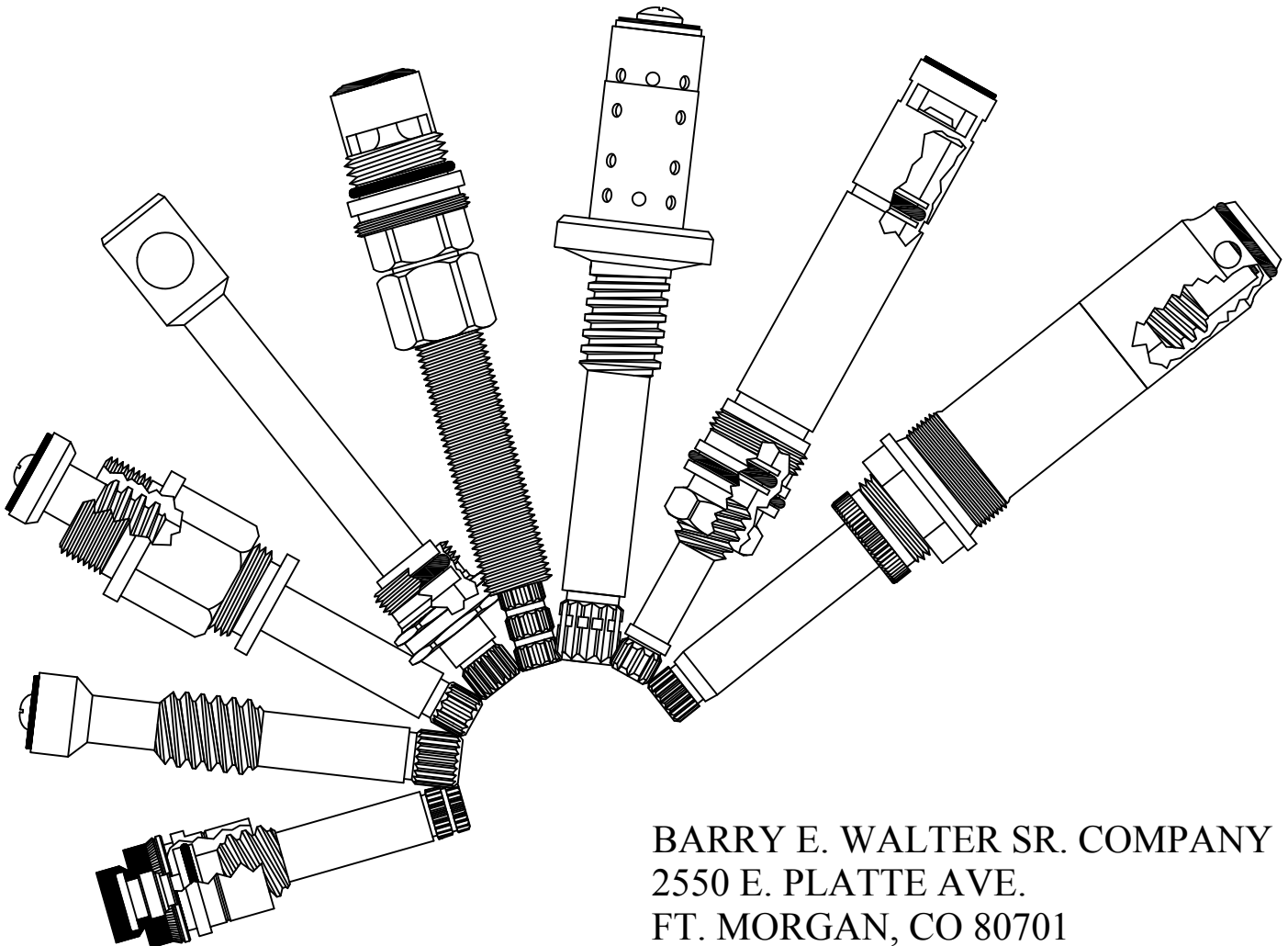

BARRY E. WALTER SR. COMPANY  
2550 E. PLATTE AVE.  
FT. MORGAN, CO 80701

# FOR J.R. SMITH

## MODELS # 5509 & 5609

PROVIDE YOUR NEEDED LENGTH FOR A QUOTE ON COMPLETE PLUNGER & OPERATING  
COUPLING ASSEMBLY, OR ORDER PART NUMBERS 983060 & 683082 OR 683062  
AND USE THREADED ROD TO MAKE YOUR OWN CUSTOM LENGTH

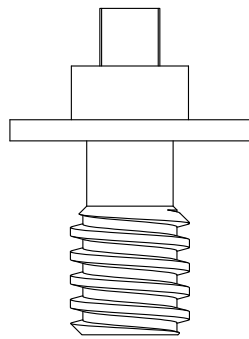

OPERATING SCREW  
COARSE THREAD  
283082

FACE NUT

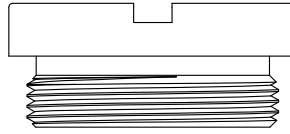

NEW STYLE  
783070



OLD STYLE  
783050

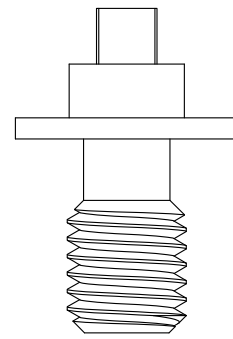

OPERATING SCREW  
FINE THREAD  
283062

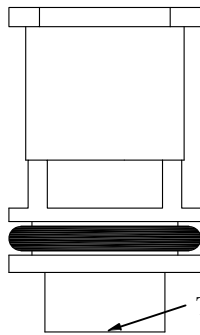

OPERATING COUPLING  
COARSE THREAD  
683082

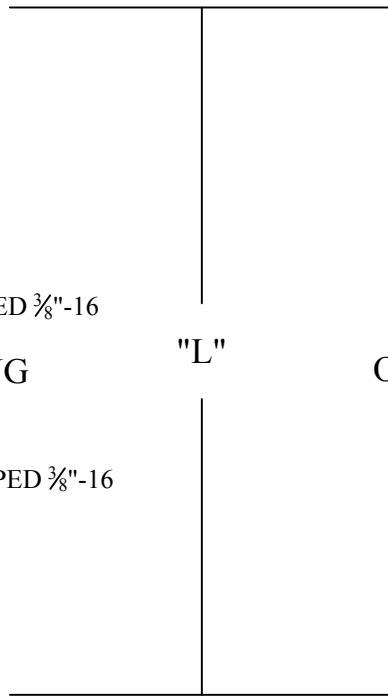

"L"

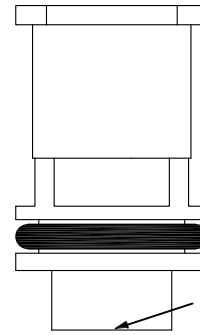

OPERATING COUPLING  
FINE THREAD  
683062

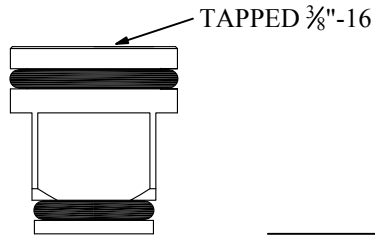

PLUNGER  
983060

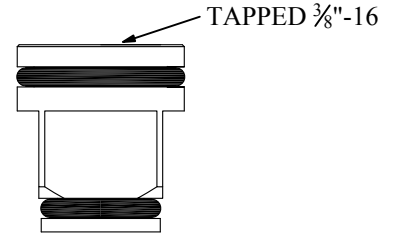

PLUNGER  
983060



BRASS SEAT  
648550

# FOR J.R. SMITH

## MODEL # 5510

PROVIDE YOUR NEEDED LENGTH FOR A QUOTE ON COMPLETE PLUNGER & OPERATING  
COUPLING ASSEMBLY, OR ORDER PART NUMBERS 983060 & 683082 OR 683062  
AND USE THREADED ROD TO MAKE YOUR OWN CUSTOM LENGTH

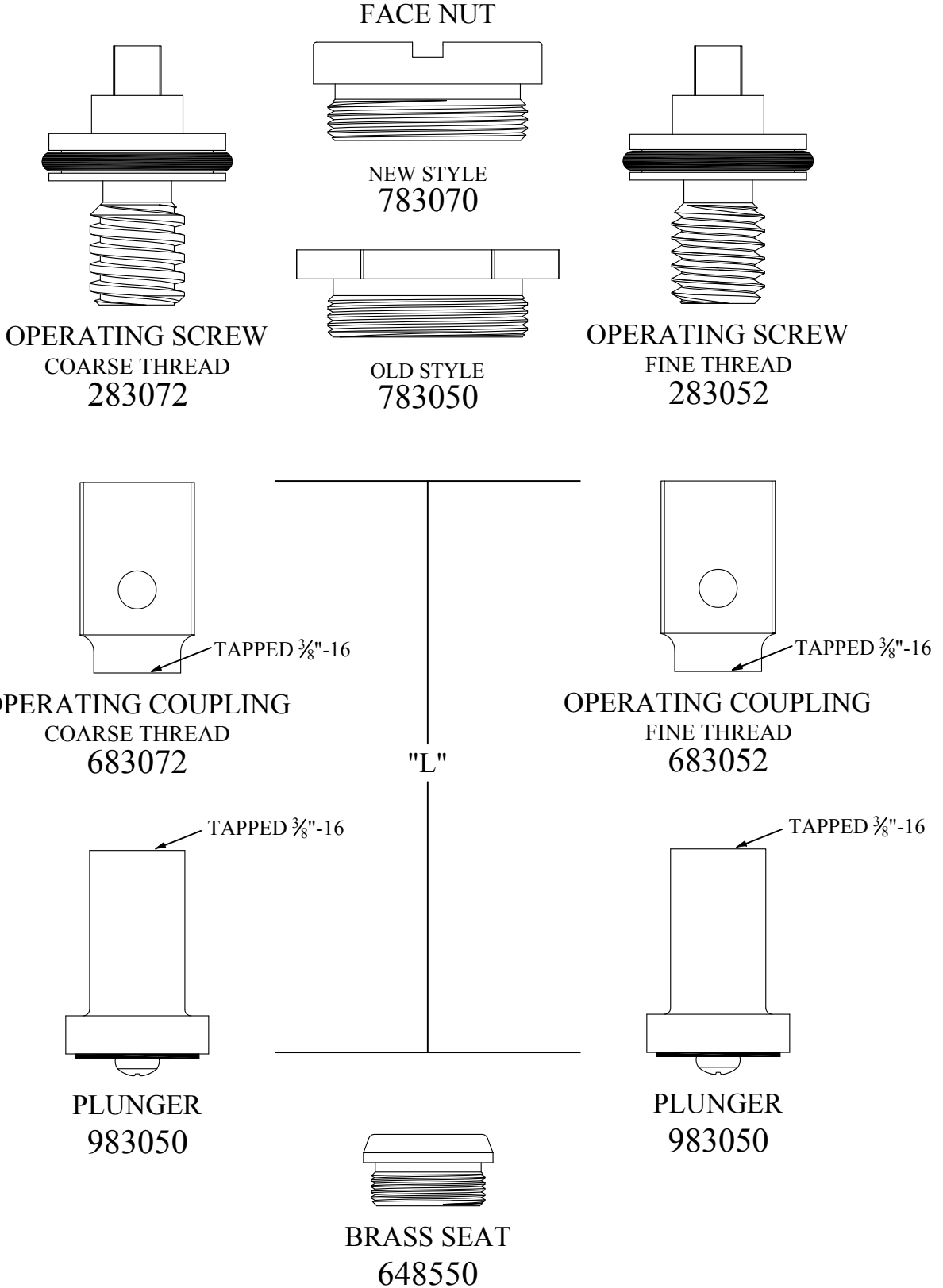



# FOR J.R. SMITH

## MODEL # 5609

PROVIDE YOUR NEEDED LENGTH FOR A QUOTE ON COMPLETE PLUNGER & OPERATING COUPLING ASSEMBLY, OR ORDER PART NUMBERS 983060 & 683072-1/2 OR 683052-1/2 AND USE 1/2" ROD TO MAKE YOUR OWN CUSTOM LENGTH (SOLDERING REQUIRED)

### FACE NUT

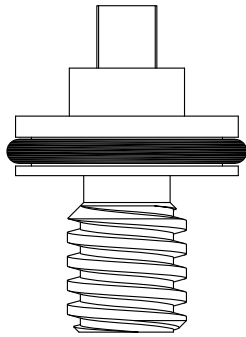

OPERATING SCREW  
COARSE THREAD  
283072

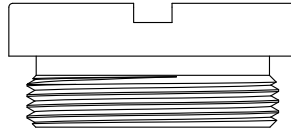

NEW STYLE  
783070



OLD STYLE  
783050

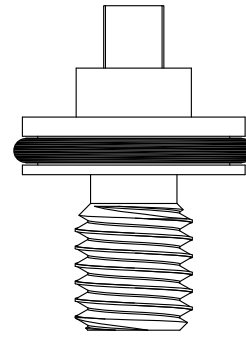

OPERATING SCREW  
FINE THREAD  
283052

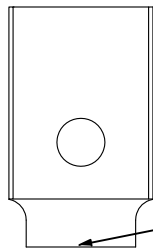

1/2" HOLE

OPERATING COUPLING  
COARSE THREAD  
683072-1/2

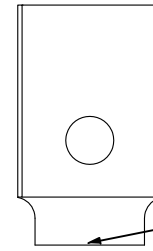

1/2" HOLE

OPERATING COUPLING  
FINE THREAD  
683052-1/2

"L"

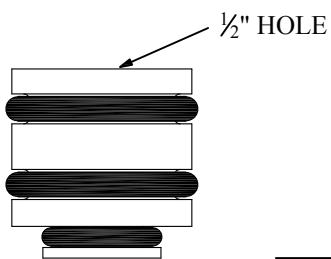

1/2" HOLE

PLUNGER  
983070

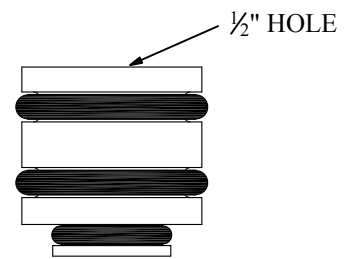

1/2" HOLE

PLUNGER  
983070



BRASS SEAT  
648550

# FOR J.R. SMITH

MODEL # 5510, 5511, 5560, 5561, 5610 & 5611

AFTER JANUARY 1979

BEFORE JANUARY 1979

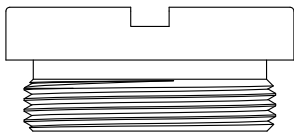

NEW STYLE  
783070

FACE NUT



OLD STYLE  
783050

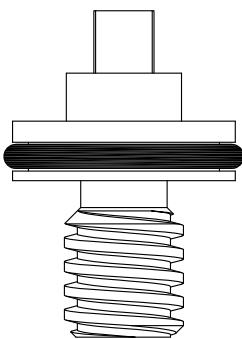

COARSE THREAD  
283072

OPERATING SCREW

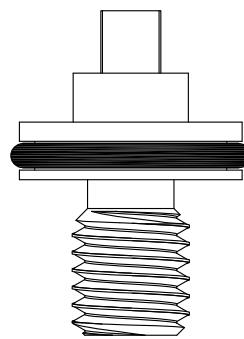

FINE THREAD  
283052

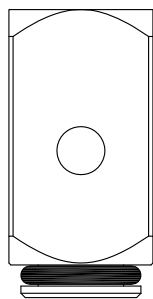

COARSE THREAD  
983042

OPERATING COUPLING /  
PLUNGER

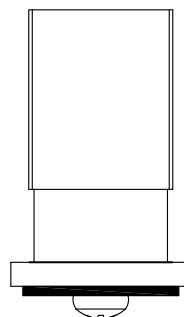

J.R. SMITH  
PLUNGER OLD STYLE  
983032



BRASS SEAT  
648550

# FOR J.R. SMITH

## MODEL # 5609QT & 5509QT

ORDER ROD ASSEMBLY PART # LENGTH FROM TABLE BELOW, OR ORDER PART NUMBERS 129840 & 129770  
AND USE A 5/16-18 THREADED ROD TO MAKE YOUR OWN CUSTOM LENGTH

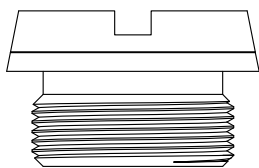

FACE NUT  
783610

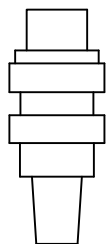

OPERATOR STEM  
283610-1

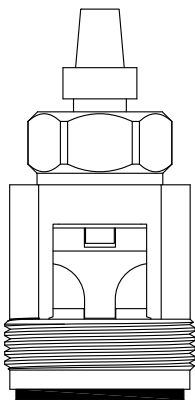

VALVE BODY  
ASSEMBLY  
483611

OPERATOR STEM  
& VALVE BODY  
ASSEMBLY  
483611-1

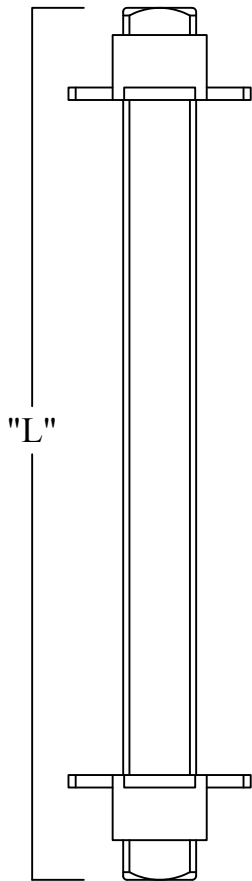

ACTUATOR ROD  
683110-  
CHOOSE A LENGTH  
FROM ABOVE TABLE

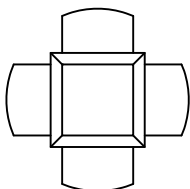

PLASTIC GUIDE  
BUSHING  
149440

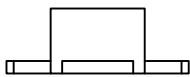

OPERATOR STEM  
WITH GUIDE BUSHING  
129840

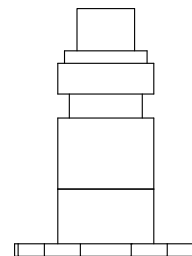

TAPPED 5/16"-18

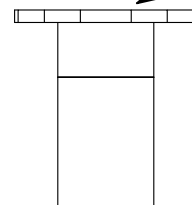

OPERATOR ADAPTER  
WITH GUIDE BUSHING  
129770

ACTUATOR ROD MADE WITH  
BRASS SQUARE TUBE & INCLUDES  
PLASTIC GUIDE BUSHINGS

PART #	"L" (LENGTH)	WALL THICKNESS
683610-1	1 3/8"	--
683610-4	4 3/8"	4"
683610-6	6 3/8"	6"
683610-8	8 3/8"	8"
683160-10	10 3/8"	10"
683160-12	12 3/8"	12"
683160-14	14 3/8"	14"
683160-16	16 3/8"	16"
683160-18	18 3/8"	18"

FOR **NIBCO**  
 SERIES #52  
 FROST-PROOF SILLCOCKS

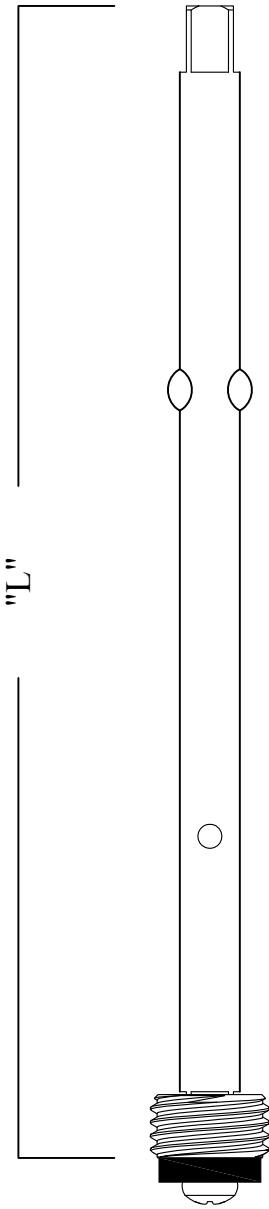

PART #	"L"	MODEL
285501-4	6"	4"
285501-6	8"	6"
285501-8	10"	8"
285501-10	12"	10"
285501-12	14"	12"
285501-14	16"	14"

# FOR PRIER

ORDER THE COMPLETE STEM, OR ORDER PART NUMBERS 123920 & 154591  
AND USE 3/8" COPPER TUBE TO MAKE YOUR OWN CUSTOM LENGTH (SOLDERING REQUIRED)

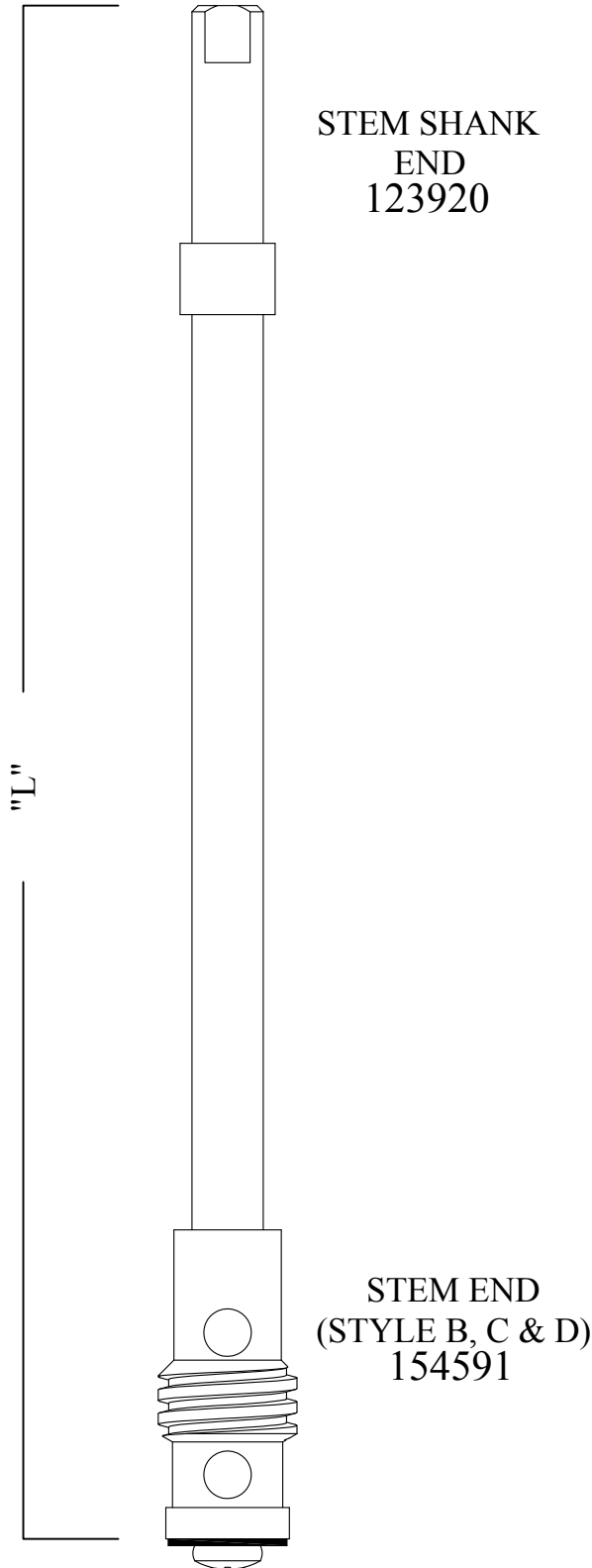

## C-134 STEM STYLE "B" (1954-1961)

PART #	"L"	MODEL
283521-4	8 1/16"	4"
283521-6	10 1/16"	6"
283521-8	12 1/16"	8"
283521-10	14 1/16"	10"
283521-12	16 1/16"	12"
283521-14	18 1/16"	14"

## C-134 STEM STYLE "C" (1961-1963)

PART #	"L"	MODEL
283531-4	7 1/16"	4"
283531-6	9 1/16"	6"
283531-8	11 1/16"	8"
283531-10	13 1/16"	10"
283531-12	15 1/16"	12"
283531-14	17 1/16"	14"

## C-134 STEM STYLE "D" (1963-1972)

PART #	"L"	MODEL
283541-4	7 5/8"	4"
283541-6	9 5/8"	6"
283541-8	11 5/8"	8"
283541-10	13 5/8"	10"
283541-12	15 5/8"	12"
283541-14	17 5/8"	14"

# FOR PRIER C-134 STEM STYLE "E" (1973-2013)

ORDER COMPLETE STEM, OR ORDER PART NUMBERS 123920 & 131221  
AND USE 3/8" COPPER TUBE TO MAKE YOUR OWN CUSTOM LENGTH (SOLDERING REQUIRED)

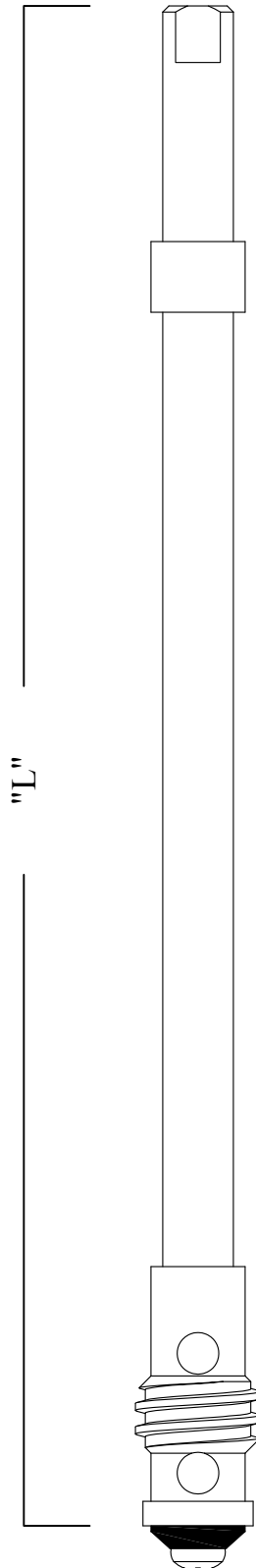

STEM SHANK  
END  
123920

PART #	"L"	MODEL
283551-4	7 5/8"	4"
283551-6	9 5/8"	6"
283551-8	11 5/8"	8"
283551-10	13 5/8"	10"
283551-12	15 5/8"	12"
283551-14	17 5/8"	14"
283551-16	19 5/8"	16"

STEM END  
(STYLE E)  
131221

# FOR PRIER C-134 STEM STYLE "G" (2013-PRESENT)

ORDER COMPLETE STEM, OR ORDER PART NUMBERS 123920 & 147651  
AND USE 3/8" COPPER TUBE TO MAKE YOUR OWN CUSTOM LENGTH (SOLDERING REQUIRED)

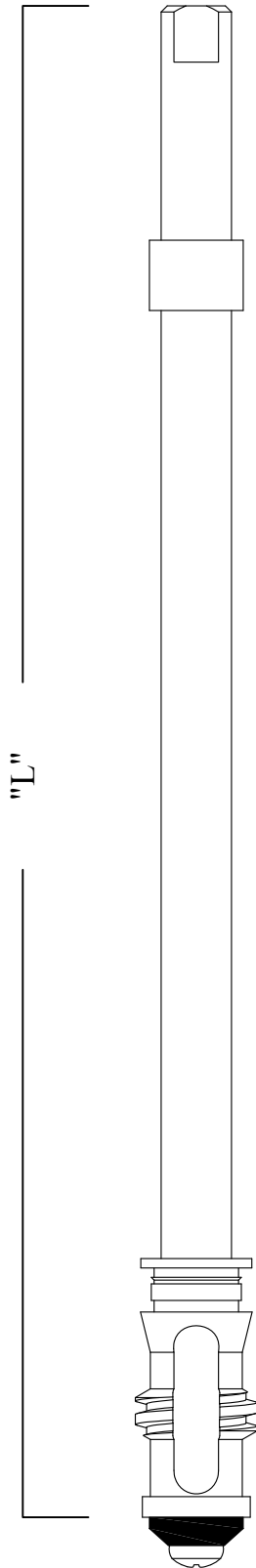

STEM SHANK  
END  
123920

PART #	"L"	MODEL
283561	4 3/8"	CLOSE COUPLED
283561-4	6 7/8"	4"
283561-6	8 7/8"	6"
283561-8	10 7/8"	8"
283561-10	12 7/8"	10"
283561-12	14 7/8"	12"
283561-14	16 7/8"	14"
283561-16	18 7/8"	16"
283561-18	20 7/8"	18"
283561-20	22 7/8"	20"
283561-22	24 7/8"	22"
283561-24	26 7/8"	24"

STEM END  
(STYLE G)  
147651

FOR **PRIER**  
SERIES C-634  
FROST-FREE WALL HYDRANT

PROVIDE YOUR NEEDED LENGTH FOR A QUOTE ON COMPLETE PLUNGER &  
DRIVE SLEEVE ASSEMBLY, OR ORDER PART NUMBERS 683312 & 983310  
AND USE THREADED ROD TO MAKE YOUR OWN CUSTOM LENGTH

ALSO AVAILABE  
CHROME PLATED  
783300-CP

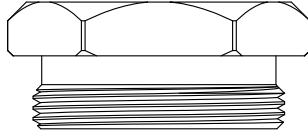

FACE NUT  
783300

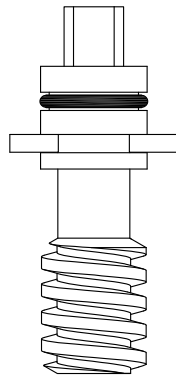

DRIVE SCREW  
ASSEMBLY  
283302

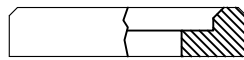

RETAINER  
883310

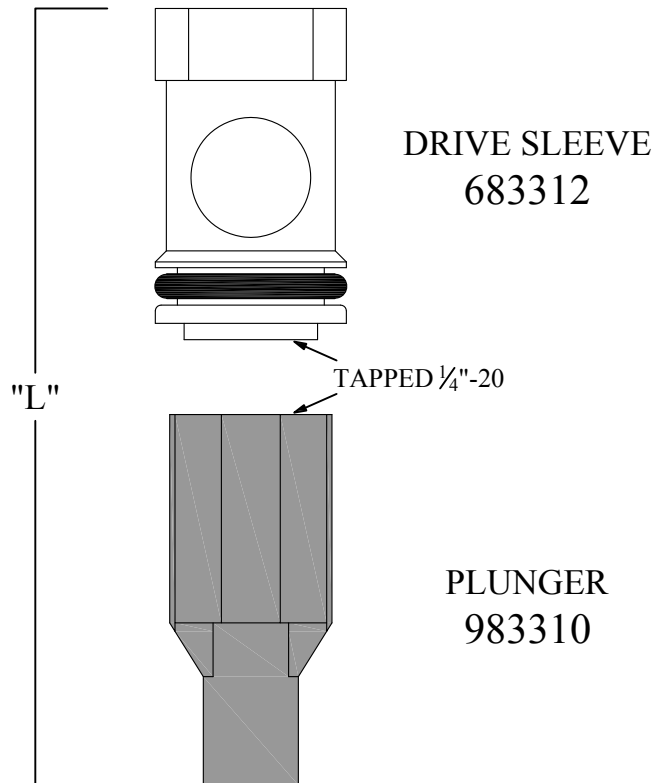

DRIVE SLEEVE  
683312

PLUNGER  
983310



FOR **WADE**  
SERIES W-8600  
FROST-FREE WALL HYDRANT

PROVIDE YOUR NEEDED LENGTH FOR A QUOTE ON COMPLETE PLUNGER &  
DRIVE SLEEVE ASSEMBLY, OR ORDER PART NUMBERS 683312 & 983310  
AND USE THREADED ROD TO MAKE YOUR OWN CUSTOM LENGTH

ALSO AVAILABE  
CHROME PLATED  
783300-CP

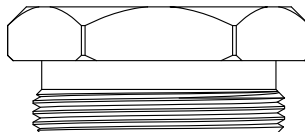

FACE NUT  
783300

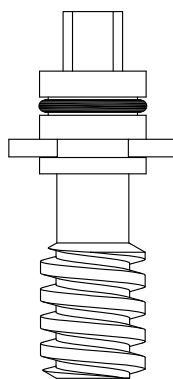

DRIVE SCREW  
ASSEMBLY  
283302

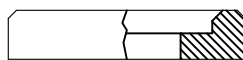

RETAINER  
883310

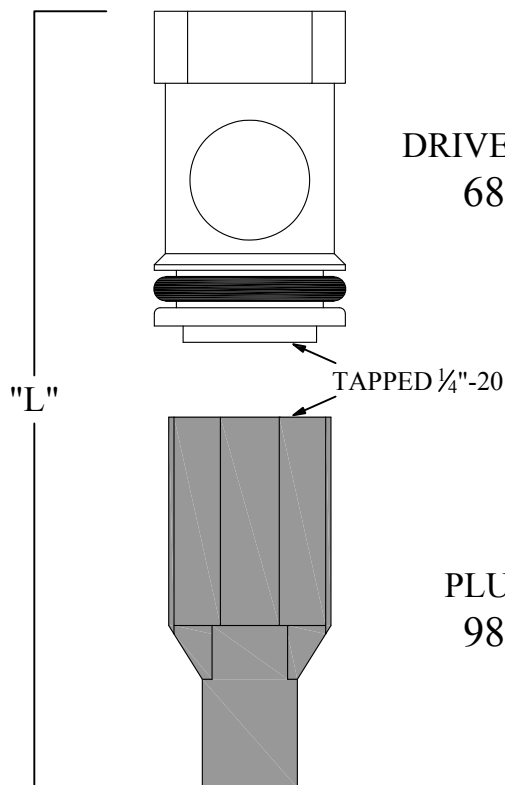

DRIVE SLEEVE  
683312

PLUNGER  
983310

FOR **WADE**

SERIES 8609 & 8610 (1" & 1 1/4")  
GROUND BOX & POST HYDRANTS

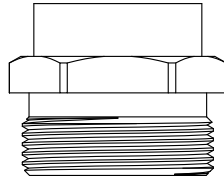

ALSO AVAILABE  
CHROME PLATED  
383200-CP

FACE NUT  
383200

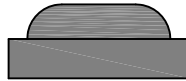

PACKING  
896320

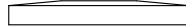

PACKING WASHER  
883200

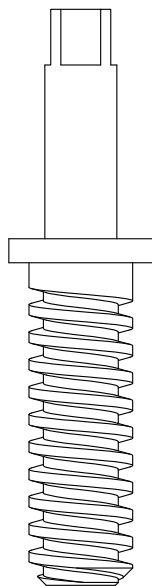

WORM STEM  
283202

FOR **WATTS**  
 SERIES # FHV-1, FHV-2 OLD STYLE  
 ANTI-SIPHON FRONT-PROOF  
 AUTOMATIC DRAINING WALL HYDRANTS

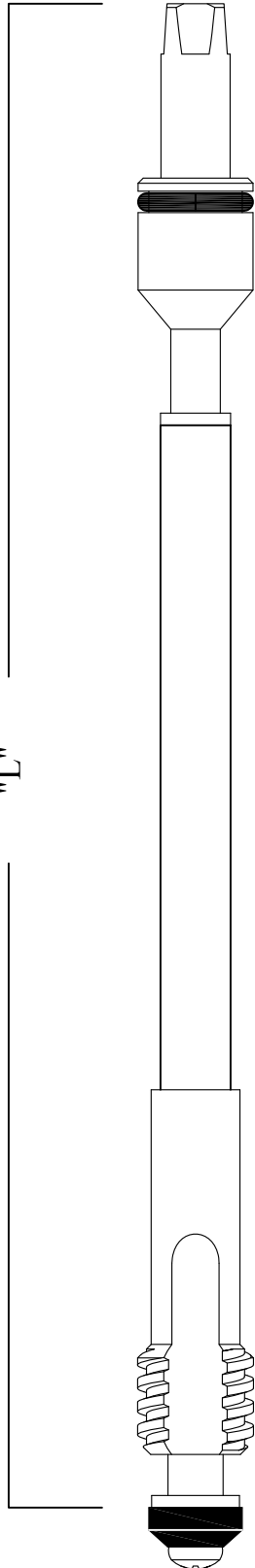

STEM SHANK  
 END  
 130990

ORDER THE COMPLETE STEM, OR ORDER 130990 &  
 130921 AND USE  $\frac{3}{8}$ " COPPER TUBE TO MAKE YOUR  
 OWN CUSTOM LENGTH.  
 (SOLDERING REQUIRED)

PART #	"L"	MODEL
283701-4	7 1/16"	4"
283701-6	9 1/16"	6"
283701-8	11 1/16"	8"
283701-10	13 1/16"	10"
283701-12	15 1/16"	12"
283701-14	17 1/16"	14"

STEM END  
 (OLD STYLE)  
 130921

FOR **WATTS**  
 SERIES # FHV-1, FHV-2 NEW STYLE  
 ANTI-SIPHON FRONT-PROOF  
 AUTOMATIC DRAINING WALL HYDRANTS

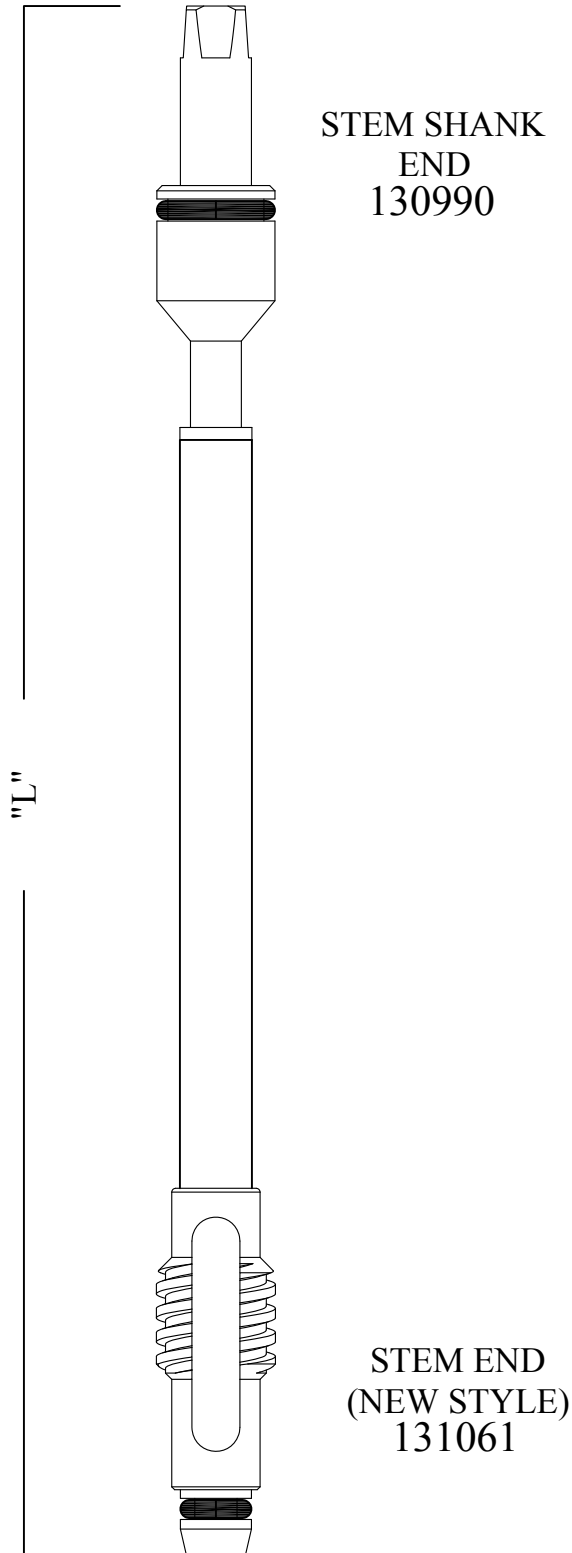

STEM SHANK  
 END  
 130990

ORDER THE COMPLETE STEM, OR ORDER  
 130990 & 131061 AND USE  $\frac{3}{8}$ " COPPER TUBE TO  
 MAKE YOUR OWN CUSTOM LENGTH.  
 (SOLDERING REQUIRED)

PART #	"L"	MODEL
283711-4	7 1/2"	4"
283711-6	9 1/2"	6"
283711-8	11 1/2"	8"
283711-10	13 1/2"	10"
283711-12	15 1/2"	12"
283711-14	17 1/2"	14"

STEM END  
 (NEW STYLE)  
 131061

# FOR WATTS / ANCON SERIES HY-400 & HY-700 WALL HYDRANTS PRIOR TO JULY 31, 1988

PROVIDE YOUR NEEDED LENGTH FOR A QUOTE ON COMPLETE PLUNGER & WORM SLEEVE  
ASSEMBLY, OR ORDER PART NUMBERS 683212 & 983200 AND USE  
THREADED ROD TO MAKE YOUR OWN CUSTOM LENGTH

ALSO AVAILABE  
CHROME PLATED  
383200-C

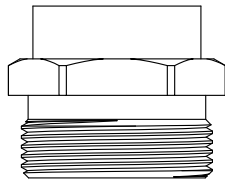

FACE NUT  
383200

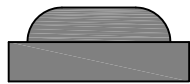

PACKING  
896320



PACKING WASHER  
883200

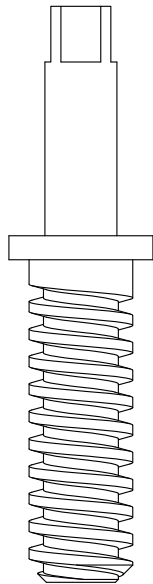

WORM STEM  
283202

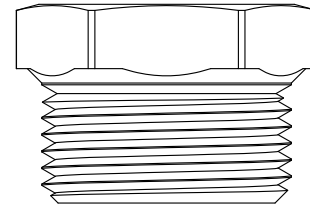

HEAD NUT  
783200

ALSO  
AVAILABE  
CHROME  
PLATED  
783200-C

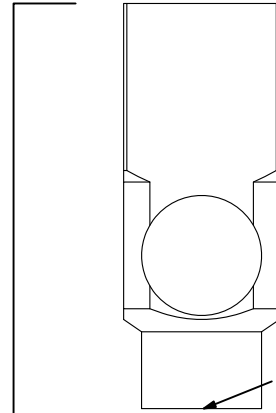

WORM SLEEVE  
683212

"L"

TAPPED  $\frac{3}{8}$ "-16

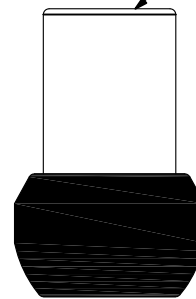

PLUNGER  
983200



PLASTIC SEAT  
646840

# FOR WATTS / ANCON

## SERIES HY-420 & HY-725 AND HY-400 & HY-700

### WALL HYDRANTS

### AFTER AUGUST 1, 1988

PROVIDE YOUR NEEDED LENGTH FOR A QUOTE ON COMPLETE PLUNGER  
& WORM SLEEVE ASSEMBLY, OR ORDER PART NUMBERS 683302 & 983430  
AND USE THREADED ROD TO MAKE YOUR OWN CUSTOM LENGTH

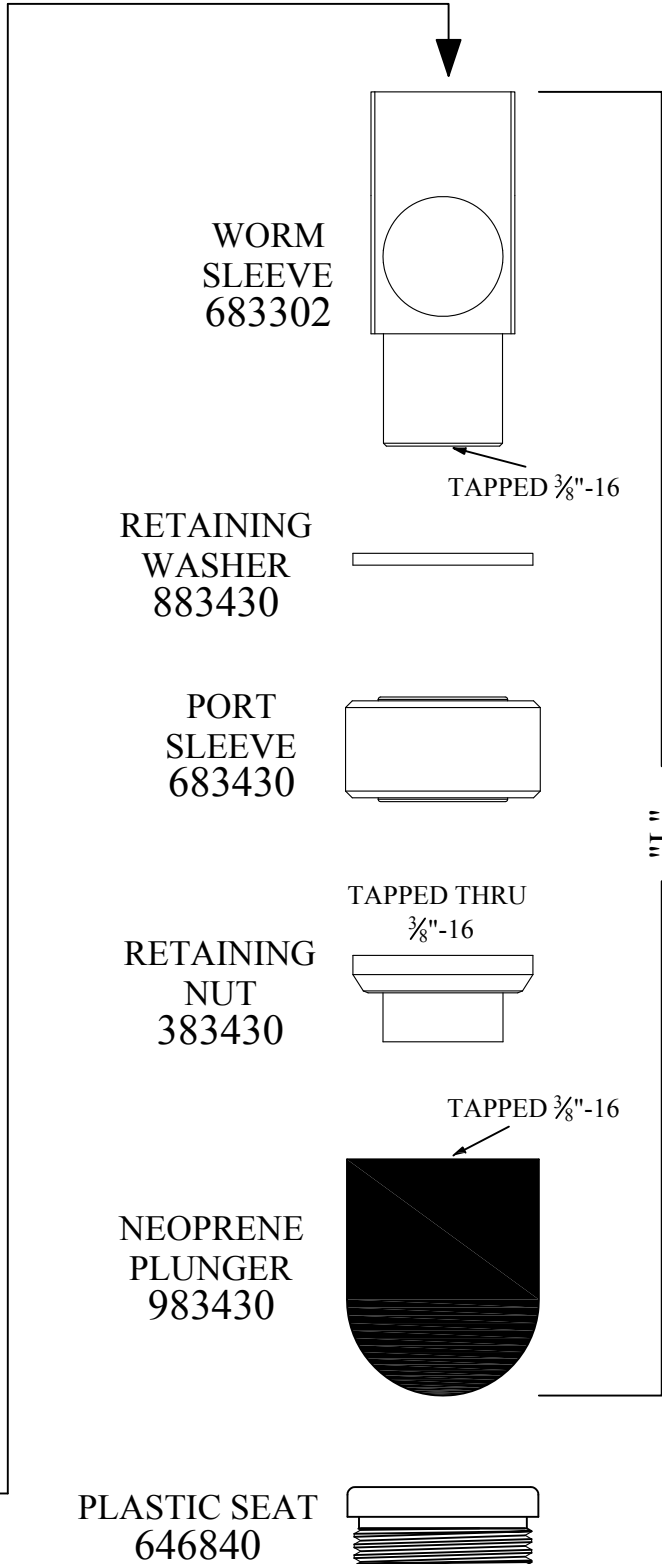
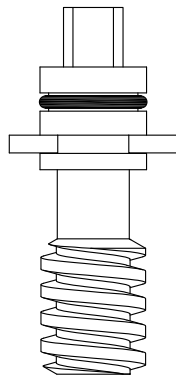
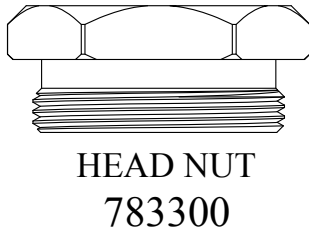

# FOR WOODFORD

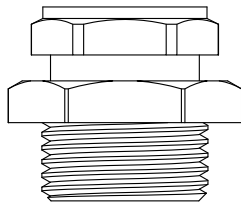

PACKING NUT  
ASSEMBLY (CHROME)  
383250-CP

FOR THE FOLLOWING  
SERIES:

SERIES 70 FREEZELESS  
WALL HYDRANT

SERIES 71, B71, 74, 75, B75, 81  
& 84 CLOSE COUPLED WALL  
HYDRANTS

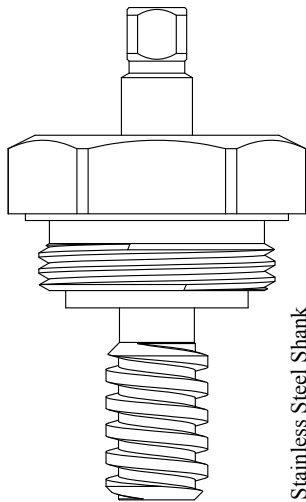

HEAD NUT  
ASSEMBLY  
483252

SERIES Y30 FREEZELESS  
YARD HYDRANT POST  
MODEL

SERIES Y70 & Y95  
FREEZELESS YARD  
HYDRANTS YARD MODEL

ALSO AVAILABLE  
CHROME PLATED  
483252-CP

# FOR ZURN

## SERIES #Z-1305, Z-1310, Z-1315 & Z-1325 FREEZELESS WALL HYDRANTS

ORDER 12" OR 24" THREADED ROD ASSEMBLY, OR ORDER PART NUMBERS 683162 & 983350  
AND USE THREADED ROD TO MAKE YOUR OWN CUSTOM LENGTH

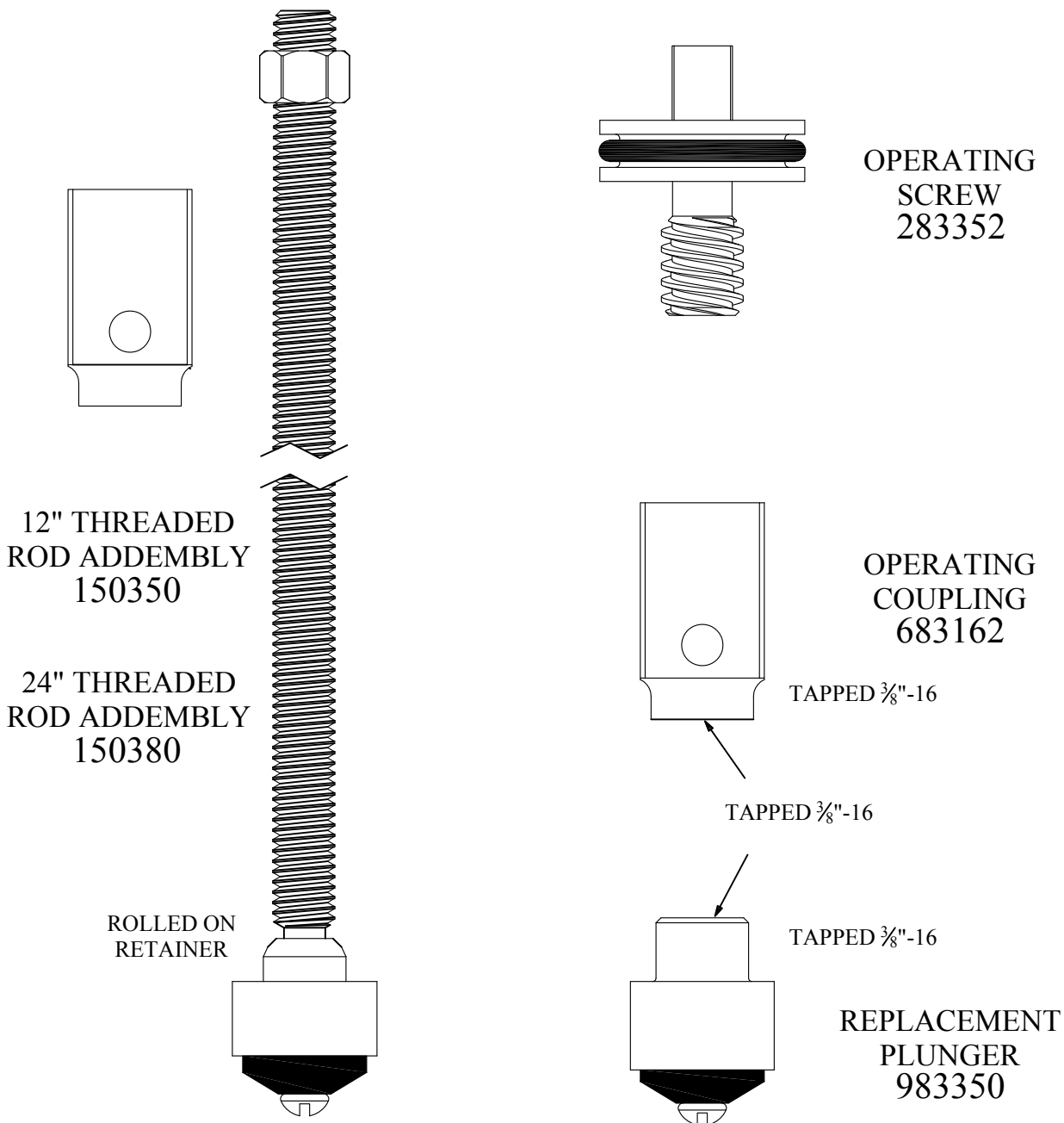



# FOR ZURN

## SERIES #Z-1320, Z-1321, Z-1500 & Z-1510 FREEZELESS ECOLOTROL WALL HYDRANTS

ORDER 12" OR 24" THREADED ROD ASSEMBLY, OR ORDER PART NUMBERS 683162 & 983160  
AND USE THREADED ROD TO MAKE YOUR OWN CUSTOM LENGTH

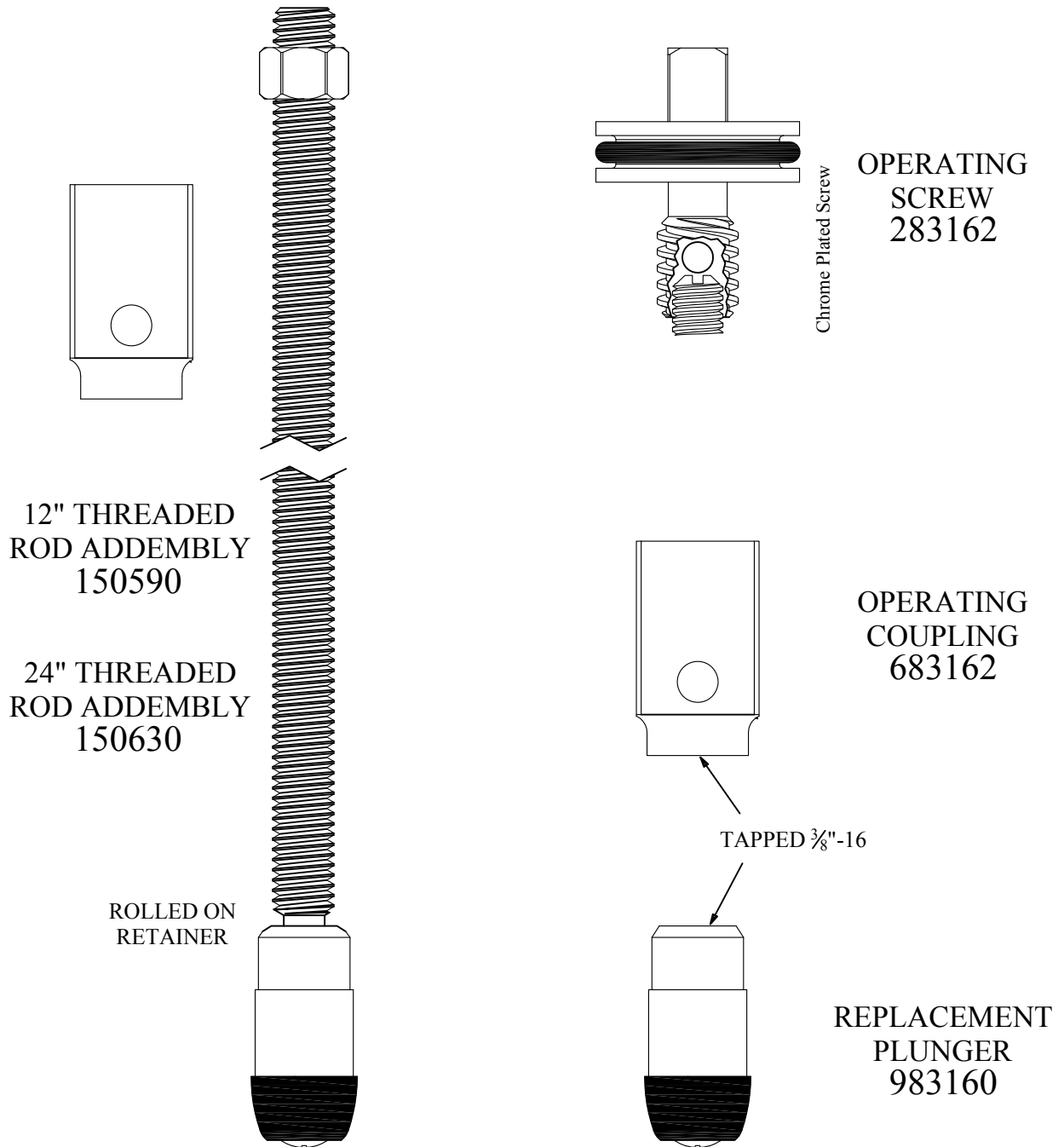

# FOR ZURN

## SERIES #Z-1320NS & Z-1321NS

### FREEZELESS, ANTI-SIPHON, AUTOMATIC DRAINING ECOLOtrol WALL HYDRANTS

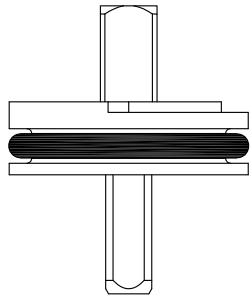

**OPERATOR**  
**283170**

Nickel Plated

ORDER THE PART NUMBER FOR DESIRED LENGTH BELOW, OR ORDER PART NUMBERS 129910 & 129980 ALONG WITH CERAMIC UNIT LF459201 AND USE 5/16"-18 THREADED ROD TO MAKE YOUR LENGTH

MADE WITH SOLID BRASS ROD  
(NOT COPPER TUBE)

PART #	"L" (LENGTH)	WALL THICKNESS
483171-6	6 1/8"	4"
483171-8	7 1/8"	6"
483171-10	8 1/8"	8"
483171-12	9 1/8"	10"
483171-14	10 1/8"	12"
483171-16	11 1/8"	14"

ANY LENGTH IS AVAILABLE IN 1" INCREMENTS  
SPECIFY NEEDED LENGTH WHEN ORDERING  
EX. 18" WALL THICKNESS USES 20 1/8" LONG ASSEMBLY.  
**ORDER 483171-20**

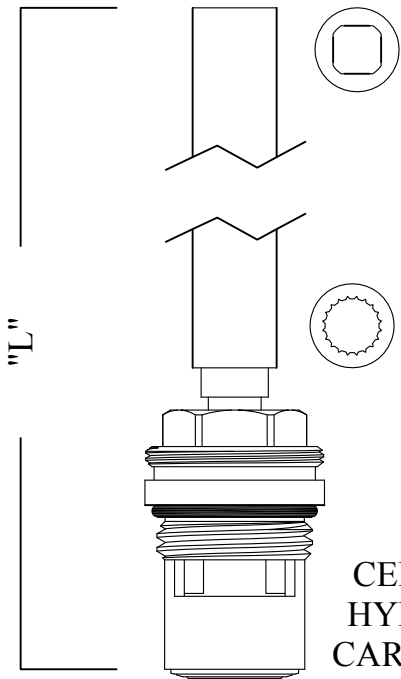

**CERAMIC  
HYDRANT  
CARTRIDGE**

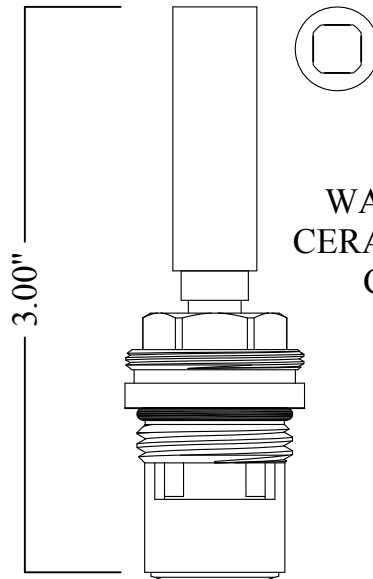
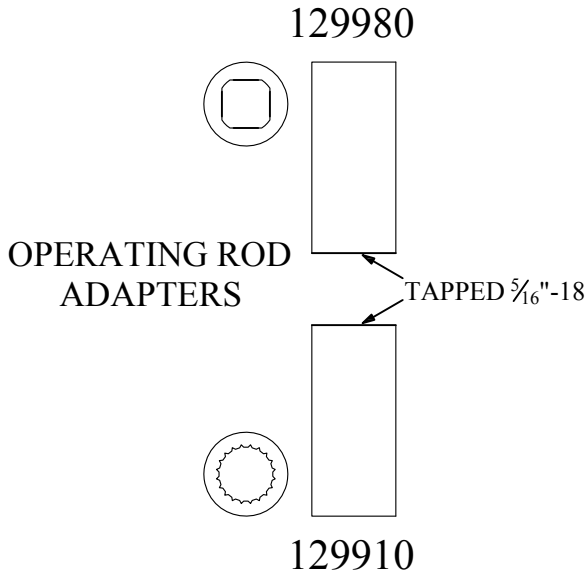

**WARM CLIMATE  
CERAMIC HYDRANT  
CARTRIDGE**  
**466311**

FOR ZURN

OLD STYLE #Z-1330  
WARM WEATHER  
HYDRANT

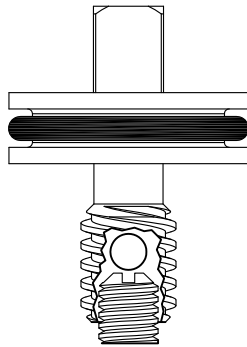

OPERATING  
SCREW  
283162

NEW STYLE #Z-1330  
WARM WEATHER  
HYDRANT

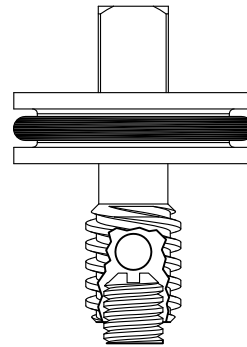

OPERATING  
SCREW  
283162

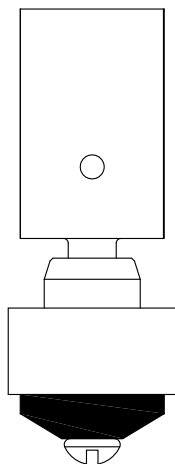

BLOCK & PLUNGER  
ASSEMBLY  
683332

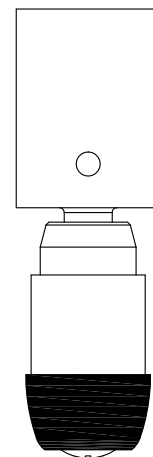

BLOCK & PLUNGER  
ASSEMBLY  
683342

FOR ZURN

JONESPEC LIGHT  
COMMERCIAL  
HYDRANT Z1341

OLD STYLE  
REVERSE THREAD

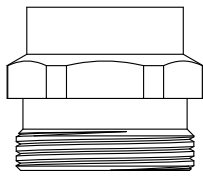

HYDRANT  
NUT  
700490



STEM  
PACKING  
896300

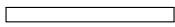

BRASS  
WASHER  
895890

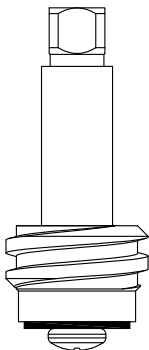

HYDRANT  
STEM  
200491

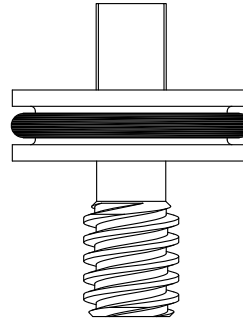

OPERATING  
SCREW  
283361

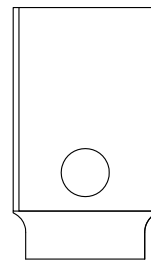

OPERATING  
COUPLING  
683361

TAPPED  $\frac{3}{8}$ "-16

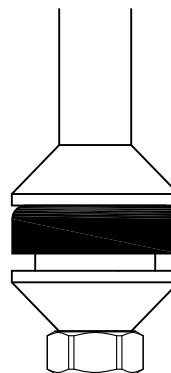

AVAILABLE AS  
SPECIAL ORDER  
W/ U-CUP  
SPECIFY LENGTH

# FOR ZURN

## HYDRANT STEM UNIT

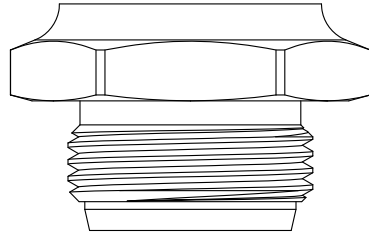

HYDRANT  
GLAND  
783401

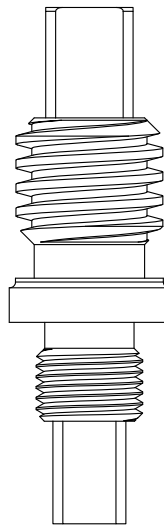

OPERATING  
SCREW  
283401

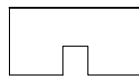

SCREW  
LOCKNUT  
983400

HYDRANT  
RETAINER  
583400

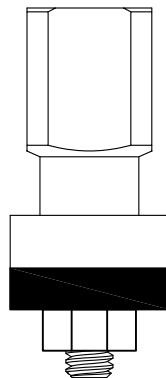

HYDRANT  
SLEEVE  
683400

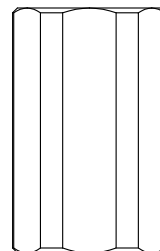

# FOR UNKNOWN

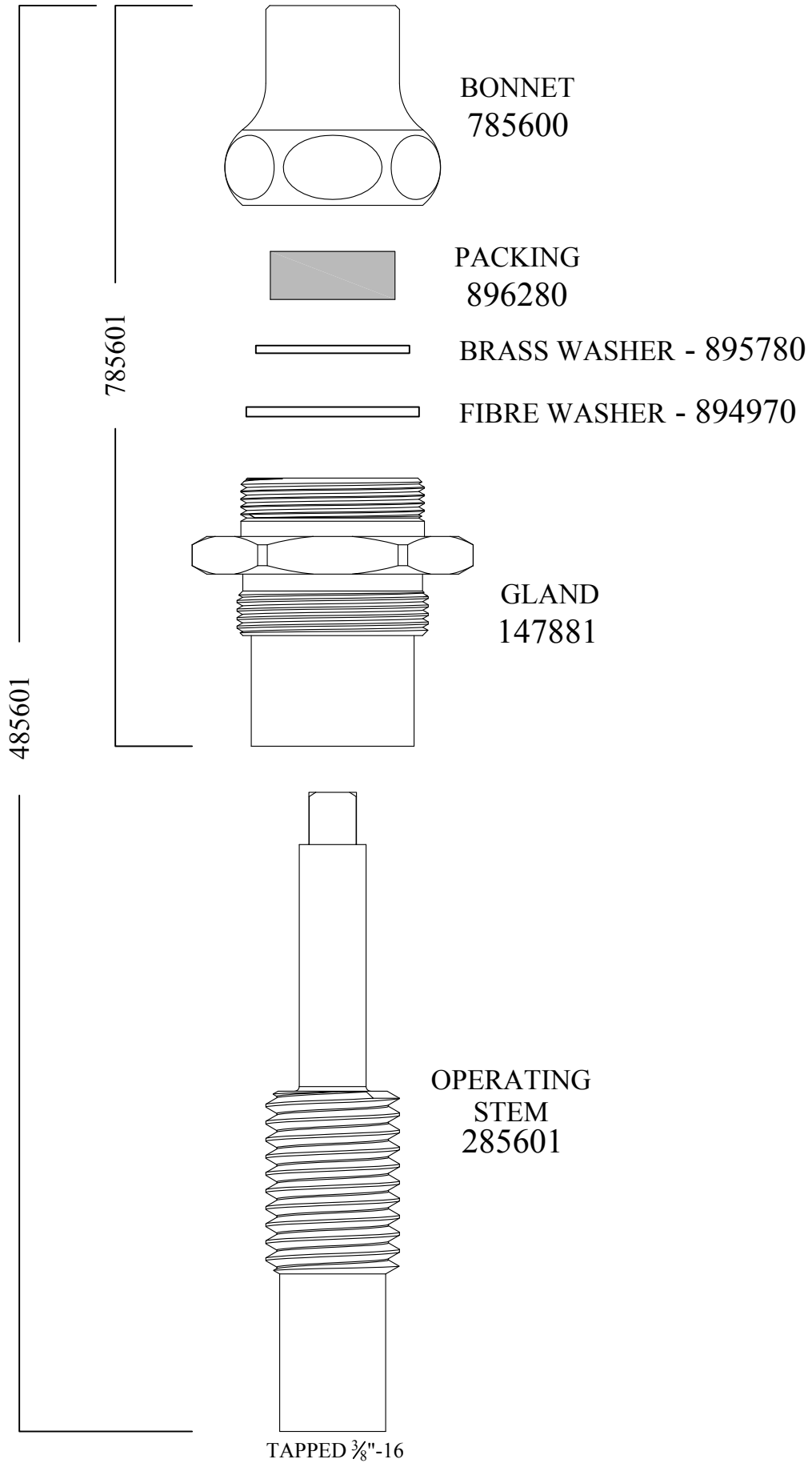

# OPERATING SCREWS & WORM STEMS

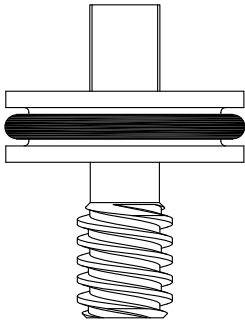

ZURN OPERATING SCREW  
NEW STYLE #3

283352

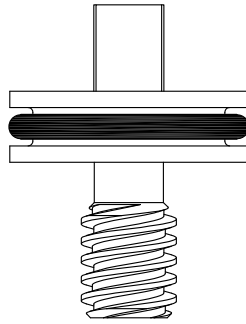

ZURN OPERATING SCREW  
OLD STYLE

283361

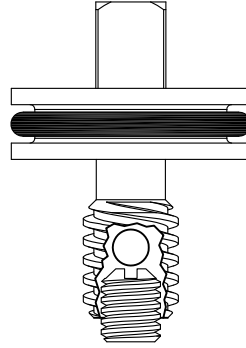

Chrome Plated Screw

ZURN OPERATING SCREW

283162

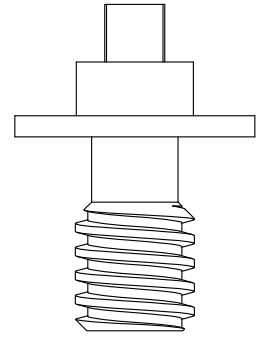

J.R. SMITH OPERATING  
SCREW COARSE THREAD

283082

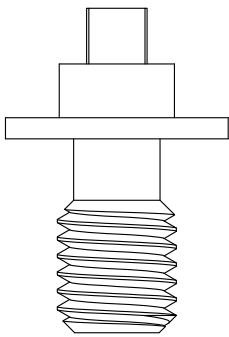

J.R. SMITH OPERATING  
SCREW FINE THREAD

283062

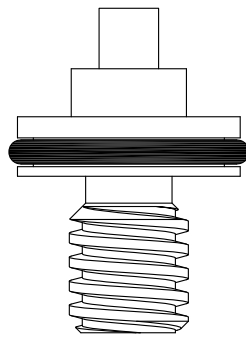

J.R. SMITH OPERATING  
SCREW COARSE THREAD

283072

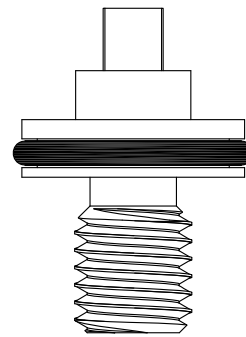

J.R. SMITH OPERATING  
SCREW FINE THREAD

283052

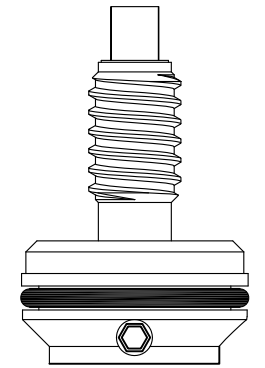

JOSAM HYDRANT STEM

283112

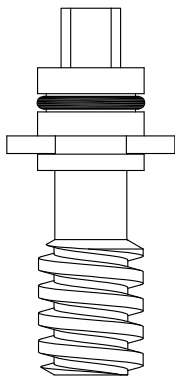

WADE HYDRANT STEM

283302

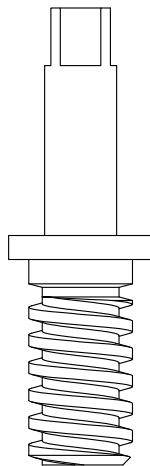

JOSAM STREET  
WASHER STEM

283192

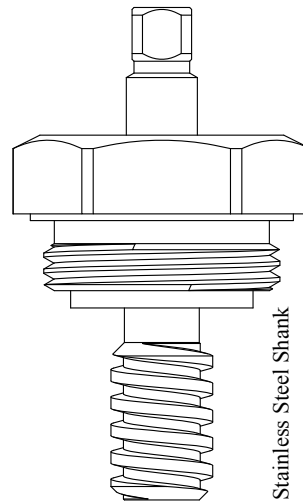

Stainless Steel Shank

WOODFORD HEAD NUT  
ASSEMBLY

483252

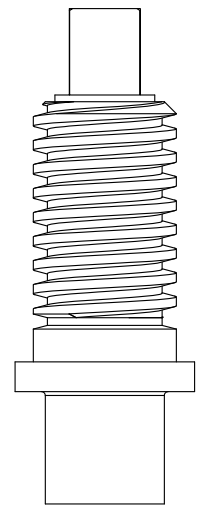

JOSAM OPERATING SCREW

283431

# OPERATING SCREWS & STEMS

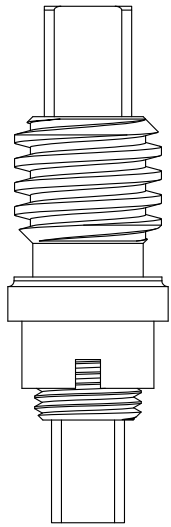

ZURN OPERATING  
SCREW

283401

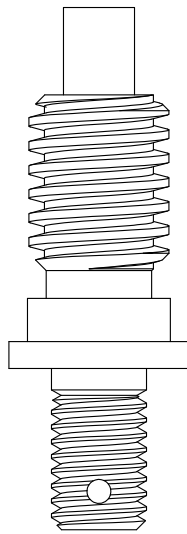

JOSAM OPERATING  
SCREW

283411

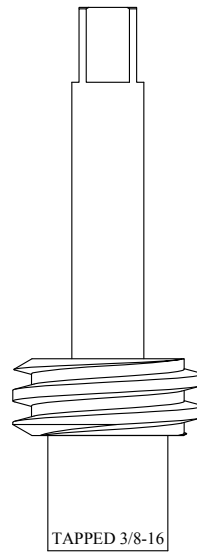

JOSAM OPERATING  
SCREW

285001

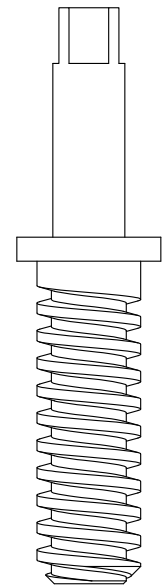

JOSAM WORM  
STEM

283202

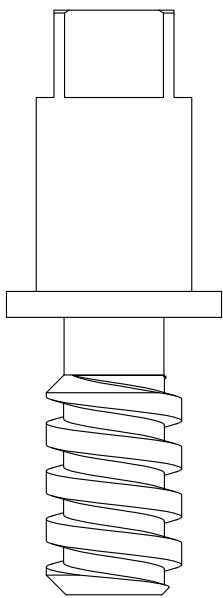

GREENBERG STREET  
WASHER STEM

283152

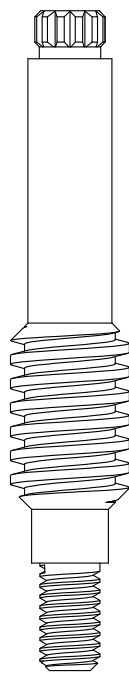

ARROWHEAD  
SANITARY STEM

181271

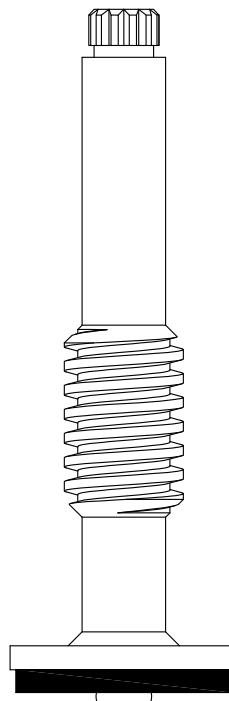

ARROWHEAD 1"  
HOSE BIBB STEM

159771

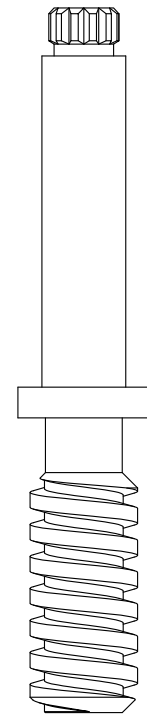

ARROWHEAD  
WEEP HOLE STEM

181342



# OPERATING SCREWS & STEMS

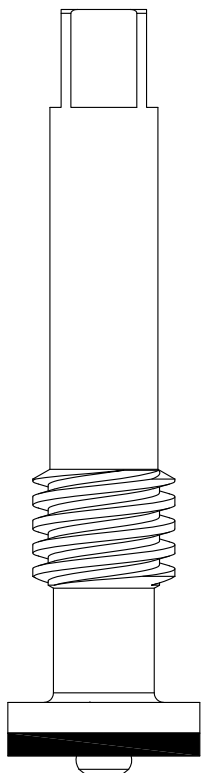

T & J STREET  
WASHER STEM

283011

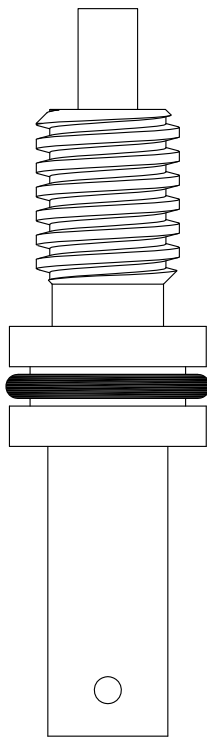

GREENBERG STREET  
WASHER STEM

283241

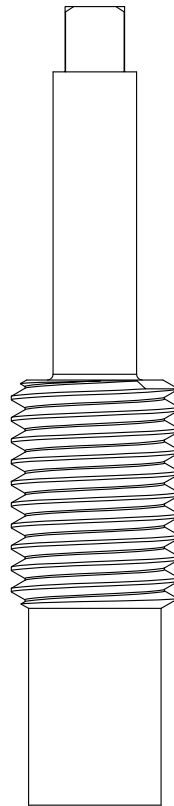

UNKNOWN HYDRANT STEM  
TAPPED  $\frac{3}{8}$ "-16

285601

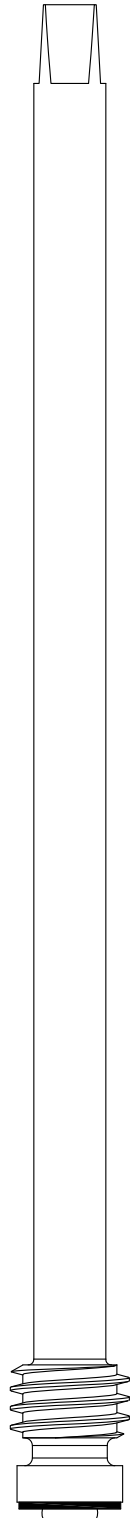

UNKNOWN HYDRANT  
STEM

152911

# OPERATING BLOCKS & WORM SLEEVES

COARSE THREAD

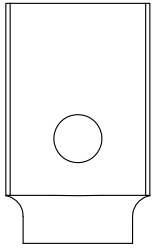

J.R. SMITH  
OPERATING BLOCK  
TAPPED  $\frac{3}{8}$ "-16  
**683072**

FINE THREAD

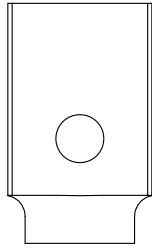

J.R. SMITH  
OPERATING BLOCK  
TAPPED  $\frac{3}{8}$ "-16  
**683052**

REVERSE THREAD

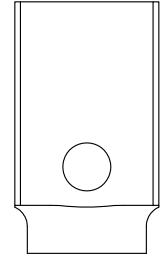

ZURN  
OPERATING BLOCK  
TAPPED  $\frac{3}{8}$ "-16  
**683361**

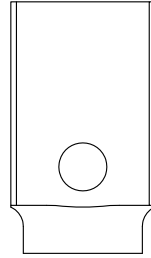

ZURN  
OPERATING BLOCK  
TAPPED  $\frac{3}{8}$ "-16  
**683162**

COARSE THREAD

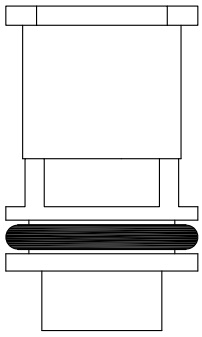

J.R. SMITH  
OPERATING BLOCK  
TAPPED  $\frac{3}{8}$ "-16  
**683082**

FINE THREAD

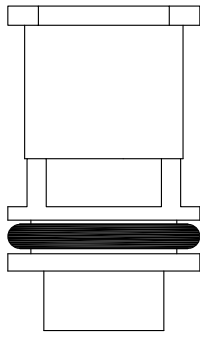

J.R. SMITH  
OPERATING BLOCK  
TAPPED  $\frac{3}{8}$ "-16  
**683062**

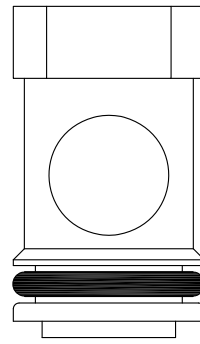

WADE  
OPERATING BLOCK  
TAPPED  $\frac{1}{4}$ "-20  
**683312**

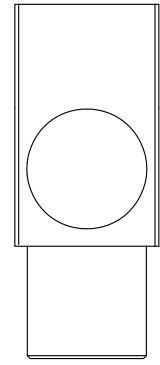

WATTS  
WORM SLEEVE  
TAPPED  $\frac{3}{8}$ "-16  
**683302**

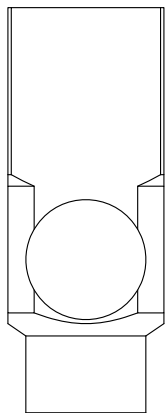

JOSAM  
WORM SLEEVE  
 $\frac{3}{8}$ " SWEAT  
**683202**

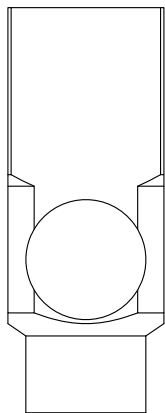

JOSAM  
WORM SLEEVE  
TAPPED  $\frac{3}{8}$ "-16  
**683212**

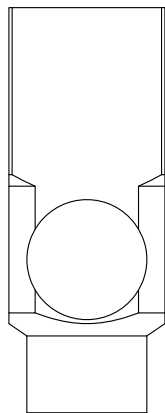

JOSAM  
WORM SLEEVE  
TAPPED  $\frac{7}{16}$ "-14  
**683222**

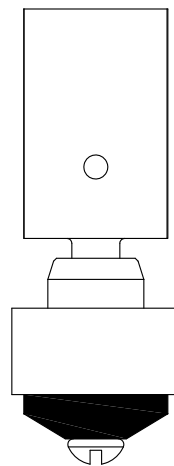

ZURN OPERATING BLOCK &  
PLUNGER ASSEMBLY (OLD STYLE)  
**683332**

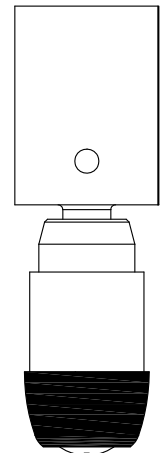

ZURN OPERATING BLOCK &  
PLUNGER ASSEMBLY  
(NEW STYLE)  
**683342**

# PLUNGER & PLUNGER ASSEMBLIES

TAPPED  $\frac{3}{8}$ "-16

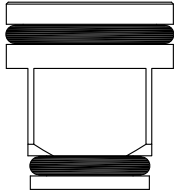

J.R. SMITH  
PLUNGER  
983060

$\frac{1}{2}$ " SWEAT

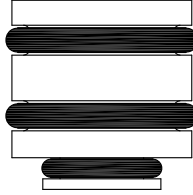

J.R. SMITH  
PLUNGER  
983070

TAPPED  $\frac{3}{8}$ "-16

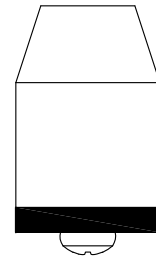

JOSAM  
PLUNGER  
985000

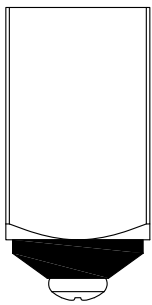

WADE PLUNGER  
983302

TAPPED  $\frac{3}{8}$ "-16

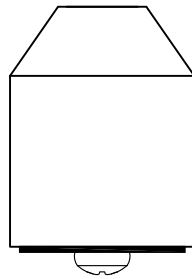

JOSAM  
PLUNGER  
983410

TAPPED  $\frac{3}{8}$ "-16

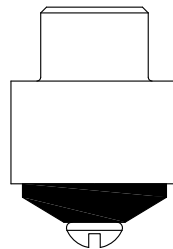

ZURN  
PLUNGER (OLD STYLE)  
983350

TAPPED  $\frac{3}{8}$ "-16

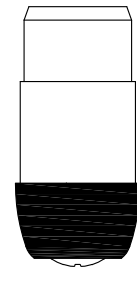

ZURN  
PLUNGER (NEW STYLE)  
983160

TAPPED  $\frac{3}{8}$ "-16

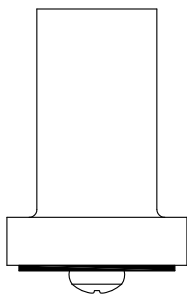

J.R. SMITH  
PLUNGER  
983050

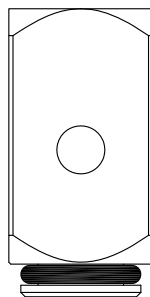

COARSE THREAD  
983042

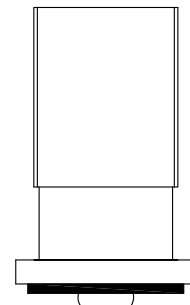

J.R. SMITH  
PLUNGER OLD STYLE  
983032

# PLUNGER & PLUNGER ASSEMBLIES

TAPPED  $\frac{3}{8}$ "-16

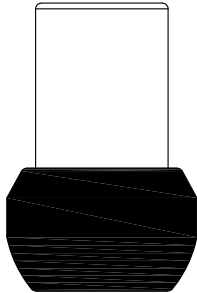

WATTS / ANCON  
PLUNGER  
983200

TAPPED  $\frac{3}{8}$ "-16

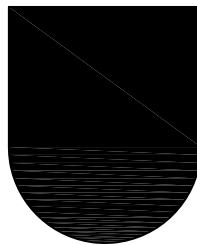

JOSAM  
PLUNGER  
983430

TAPPED  $\frac{1}{4}$ "-20

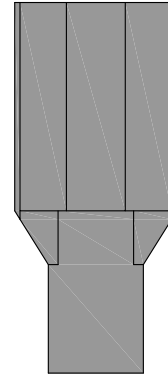

PRIER PLUNGER  
983310

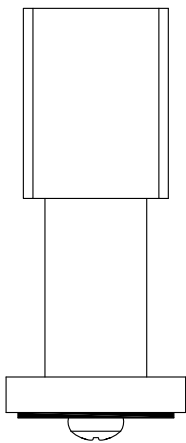

J.R. SMITH  
COUPLING PLUNGER  
983092

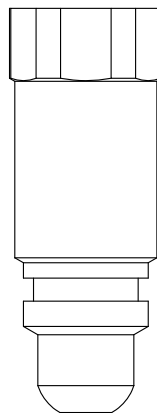

ARROWHEAD  
WEEP HOLE PLUNGER  
182670

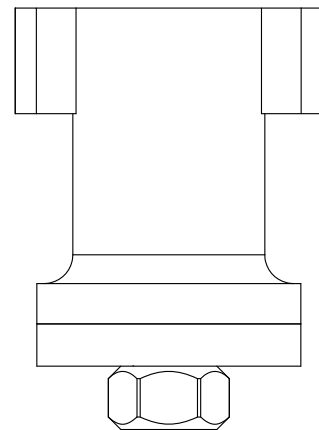

GREENBERG STREET  
WASHER PLUNGER  
983152

# WORM, FACE, HEAD AND PACKING NUTS



J.R. SMITH  
FACE NUT (OLD STYLE)

783050

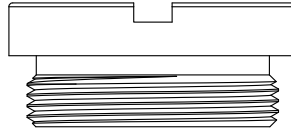

J.R. SMITH  
FACE NUT (NEW STLYE)

783070

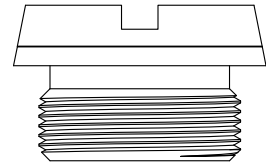

J.R. SMITH  
FACE NUT

783610

Also available chrome plated

783300-CP

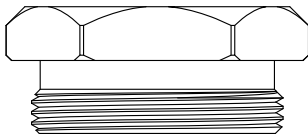

WADE  
FACE NUT

783300

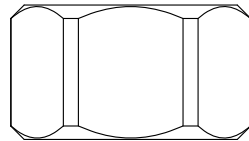

ARROWHEAD  
HOSE BIBB NUT

159840

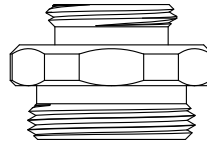

B & K  
FREEZE-PROOF GLAND

785700

Also available chrome plated

383200-CP

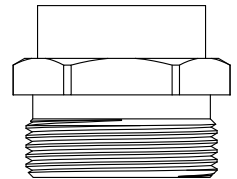

WADE  
PACKING NUT

383200

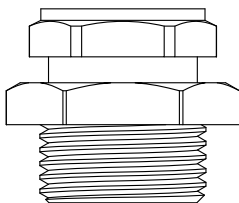

Chrome Plated

WOODFORD  
PACKING NUT ASSEMBLY

383250-CP

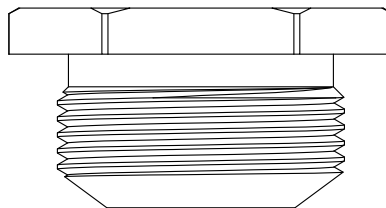

JOSAM  
HEAD NUT

783411

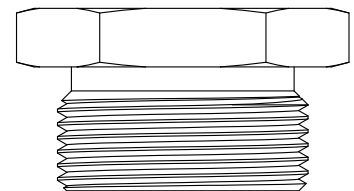

GREENBERG  
PACKING NUT

383150

# WORM, FACE, HEAD AND PACKING NUTS

Also available chrome plated

**783200-CP**

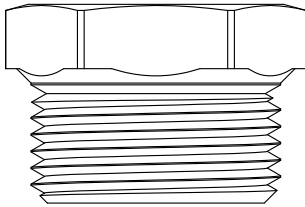

JOSAM  
HEAD NUT

**783200**

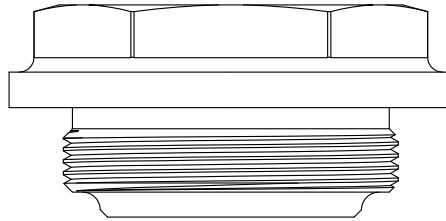

GREENBERG  
HEAD NUT

**109540**

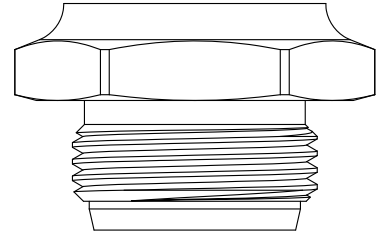

ZURN  
HEAD NUT

**783401**

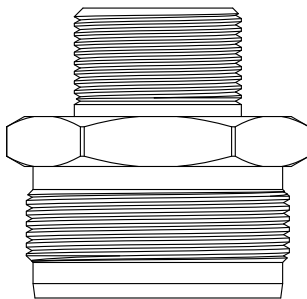

JOSAM  
DRAW NUT

**783112**

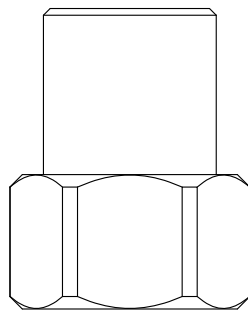

ARROWHEAD  
LOOSE KEY NUT

**106300**

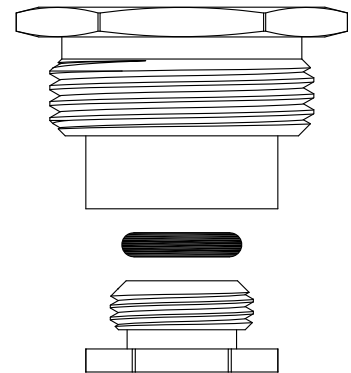

JOSAM  
HEAD NUT ASSEMBLY

**785000**

# ADAPTERS

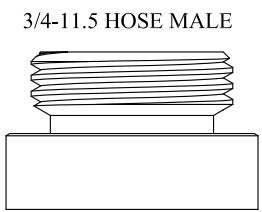

3/4-11.5 HOSE MALE  
HOSE BIBB ADAPTER  
1-3/16-20 FEMALE

147020

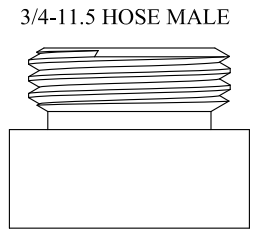

3/4-11.5 HOSE MALE  
HOSE BIBB ADAPTER  
1-1/16-20 FEMALE

130080

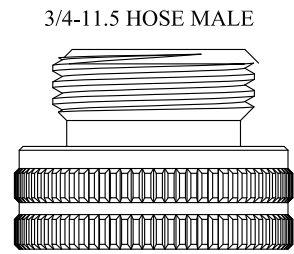

3/4-11.5 HOSE MALE  
HOSE BIBB ADAPTER  
1" - 11.5 NPS FEMALE

146040

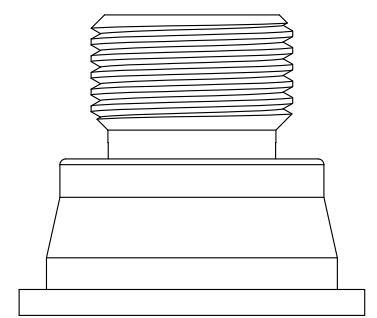

ZURN NOZZLE  
3/4-11.5 HOSE MALE

149090  
OEM# 50799-005

# SEATS

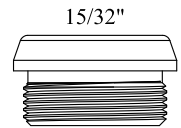

15/32"  
J.R. SMITH SEAT  
3/4-27

649550

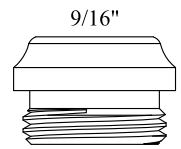

9/16"  
ZURN HYDRANT SEAT  
3/4-16

646920  
OEM# P1310-#16

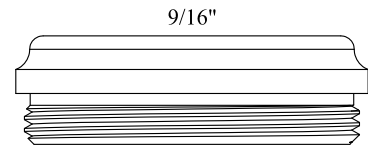

9/16"  
ZURN HYDRANT SEAT

646830

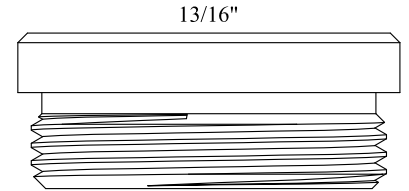

13/16"  
JOSAM / WADE / PRIER SEAT

646840

# TOOLS

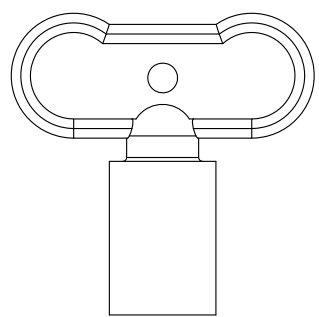

HYDRANT HANDLE  
5/16 SQUARE

999030

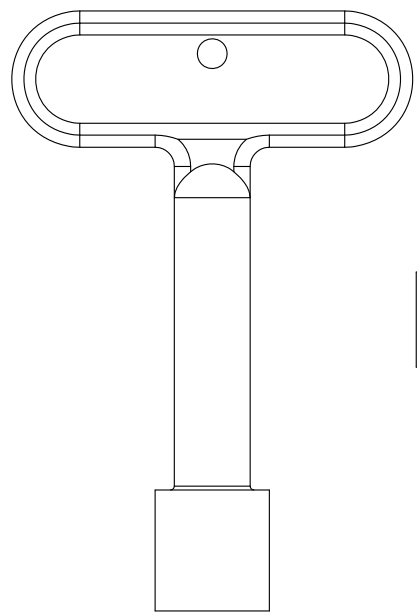

HYDRANT HANDLE  
5/16 & 3/8 SQUARE

999040

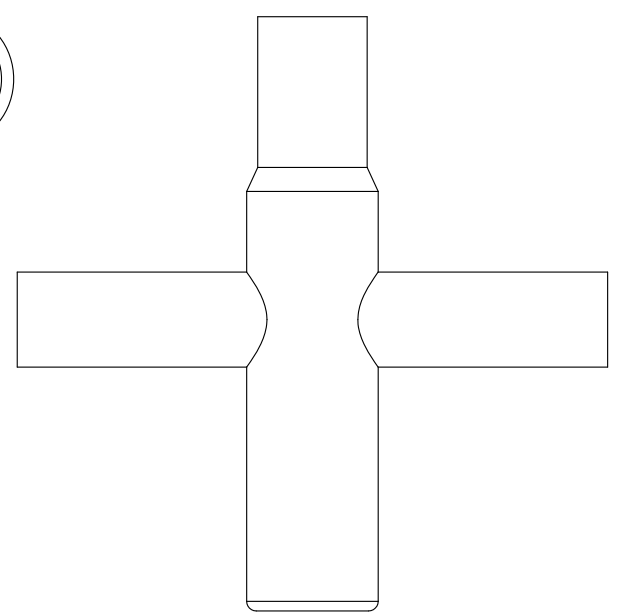

4 IN 1 HYDRANT KEY

999050

# MISCELLANEOUS

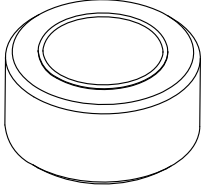

JOSAM DRAIN  
PORT SLEEVE

**683430**

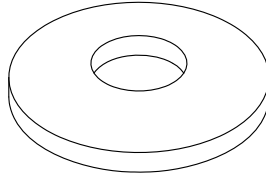

ZURN EQUA-BALANCE  
SEALT

**147760**  
OEM# P1310-#23  
50785-001

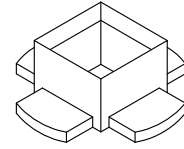

J.R. SMITH PLASTIC  
GUIDE BUSHING

**149440**

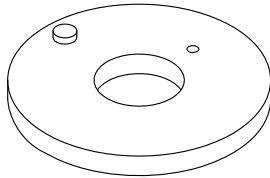

ZURN RETAINING WASHER

**LF150140**  
OEM# 602280012

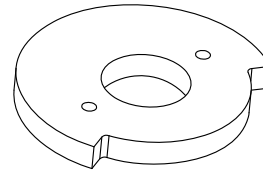

J.R. SMITH RETAINING WASHER

**151710**  
OEM# 602280012

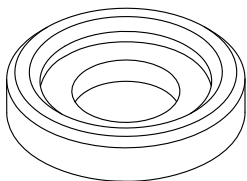

PRIER / WADE / JOSAM  
PLASTIC RETAINER SEAL

**883310**  
PRIER OEM# 391-4008

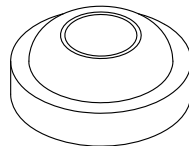

JOSAM / PRIER / WADE  
PACKING

**896320**

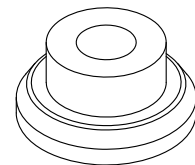

JOSAM HYDRANT  
RETAINING NUT

**383430**