

**AMERICAN STANDARD\***

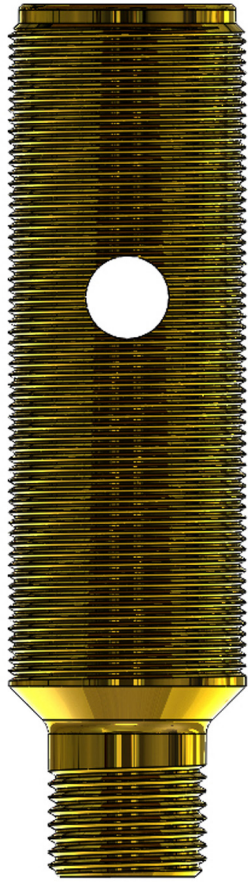

**Re-Nu Lav Valve Body**  
LF155770  
4.58"

**AMERICAN STANDARD\***

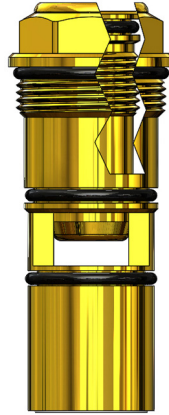

**Check Stop Unit - Hot**  
400540H  
2.15"  
R510 Valve  
OEM: 953951-0070a

**AMERICAN STANDARD\***

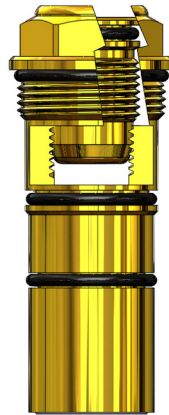

**Check Stop Unit - Cold**  
400540C  
2.15"  
R510 Valve  
OEM: 953950-0070a

**CALIFORNIA FAUCETS\***



**Thermostatic Cartridge**  
488160-RES  
4.05"  
With Restrictor

To Order, Email [Orderdesk@barrywalter.com](mailto:Orderdesk@barrywalter.com) or Fax 1-800-886-9831 - [BarryWalter.com](http://BarryWalter.com)

\*Original Mfg's names are used for identification only and are not a representation that the items offered are genuine items of the original Mfg.

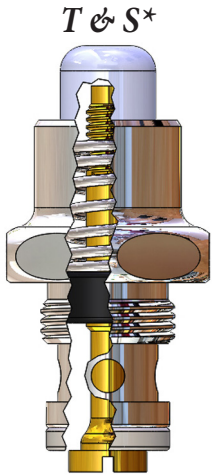

**T & S\***  
**Knee Valve**  
LF462400-P  
2.25"  
Plastic Button  
OEM: 002983-40

**UNKNOWN**

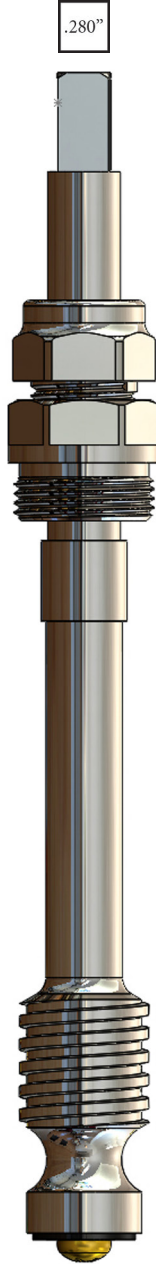

**S/V Unit**  
427401  
6.20"

**UNKNOWN**

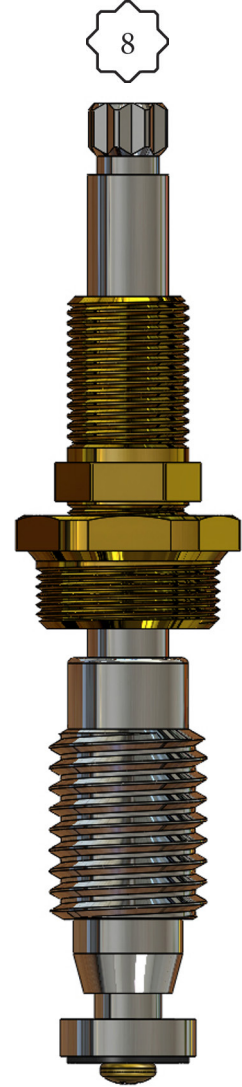

**S/V Unit**  
416241  
5.14"

To Order, Email [Orderdesk@barrywalter.com](mailto:Orderdesk@barrywalter.com) or Fax 1-800-886-9831 - [BarryWalter.com](http://BarryWalter.com)

\*Original Mfg's names are used for identification only and are not a representation that the items offered are genuine items of the original Mfg.